

EuroCave®



Mode d'emploi - Gamme Compact 59
Technical Manual - Compact 59 Range
Gebrauchsanweisung - Reihe Compact 59
Modo de empleo - Gama Compact 59

Des solutions adaptées à tous vos besoins - Solutions to meet all your needs
 All Ihren Bedürfnissen angepaßte Lösungen - Soluciones adaptadas a todas sus necesidades

ARMOIRES À VINS - WINE CABINETS WEINKLIMASCHRÄNKE - ARMARIOS PARA VINOS



First



Classic



Compact



Cuir - Leather - Leder - Cuero



Meuble à Vins



Sommelier

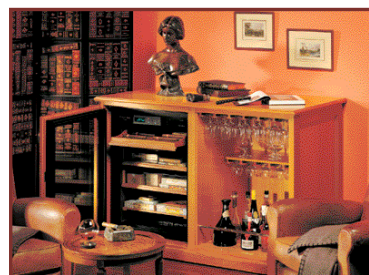

Elite

SYSTÈMES DE RANGEMENT - STORAGE SYSTEMS REGALSYSTEME - SISTEMAS DE COLOCACIÓN



Modulothèque



Modulocube



Modulorack

CLIMATISEURS DE CAVE
 CELLAR CONDITIONERS
 WEINKELLERKLIMAGERÄTE
 CLIMATIZADORES PARA BODEGA



CL-C*



CL-A*

SERVICE DU VIN AU VERRE
 SYSTEM TO SERVE WINES BY THE GLASS
 OFFENAUSSCHANKSYSTEM
 DISPENSADOR DE VINO POR COPA



Vin au Verre

* Produit non disponible dans certains pays. Product not available in certain countries.

WELCOME TO THE WORLD OF EUROCAVE

Our principle aim is to the best of our ability to enhance your enthusiasm for wine throughout the years ...To achieve this, EuroCave uses all its know-how to bring together the 6 criteria essential to wine maturing:

Temperature:

The two worst enemies of wine are extreme temperatures and wildly fluctuating temperatures. A constant temperature of 10 to 14°C (50 to 57°F) is considered ideal for wine to reach its peak.

Humidity:

This is an essential factor, enabling the corks to retain their sealing characteristics. The humidity level should be higher than 50% (ideally between 60 and 75%).

Darkness:

Light, and more especially its ultra-violet content, has a rapid and harmful effect on wine through the irreversible oxidation of the tannins. For this reason it is strongly recommended that you store your wine in the dark and away from U.V. rays.

Lack of vibration:

Vibration disturbs the slow process of biochemical evolution in wine and is often fatal to the finer 'crus'.

Storage:

Moving your wine bottles around too often is detrimental to correct wine preservation. Having appropriate storage that cuts down on handling is essential.

Natural ventilation:

A constant supply of filtered air from the outside is indispensable if unpleasant smells and mould development are to be avoided.

All of these criteria are embodied in the EuroCave Compact cabinet that you have just acquired. We thank you for the faith you have shown in us.

Standard wine service temperatures

French Wines













Alsace	10°C / 50°F
Beaujolais	13°C / 55°F
Sweet white Bordeaux	6°C / 43°F
Dry white Bordeaux	8°C / 46°F
Bordeaux reds	17°C / 63°F
White Burgundy	11°C / 52°F
Burgundy reds	18°C / 64°F
Champagne	6°C / 43°F
Jura	10°C / 50°F
Languedoc-Roussillon	13°C / 55°F
Provence Rosé	12°C / 54°F
Savoie	9°C / 48°F
Dry white Loire wines	10°C / 50°F
Sweet white Loire wines	7°C / 45°F
Loire reds	14°C / 57°F
Rhône wines	15°C / 59°F
Sweet wines from the South-West	7°C / 45°F
Reds from the South-West	15°C / 59°F

Australian Wines

Cabernet franc	16°C / 61°F
Cabernet sauvignon	17°C / 63°F
Chardonnay	10°C / 50°F
Merlot	17°C / 63°F
Muscat à petit grain	6°C / 43°F
Pinot noir	15°C / 59°F
Sauvignon blanc	8°C / 46°F
Semillon	8°C / 46°F
Shiraz	18°C / 64°F
Verdheho	7°C / 45°F

Other wines

Californian	16°C / 61°F
Chile	15°C / 59°F
Spanish	17°C / 63°F
Italian	16°C / 61°F

	1 • DESCRIPTION OF YOUR WINE CABINET	p. 5
	2 • IMPORTANT SAFETY RECOMMENDATIONS	p. 6
	3 • POWER SUPPLY	p. 6
	4 • ENVIRONMENTAL PROTECTION AND POWER SAVING	p. 6
	5 • INSTALLING YOUR WINE CABINET	
	I- In general	p. 7
	II- Building in and reversibility	p. 8
	a- Summary of parts	p. 8
	b- Building in	p. 9
	c- Reversibility of door	p. 11
	6 • ARRANGEMENT AND STORAGE	
	I- Various storage methods	p. 13
	II- Advice on arranging your wine cabinet	p. 13
	III- Adding sliding shelves	p. 13
	IV- Modifying the layout of your cabinet	p. 14
	7 • COMMISSIONING YOUR WINE CABINET	
	I- Connecting up your wine cabinet	p. 14
	II- Switching on the cabinet	p. 14
	III- Control panel description	p. 15
	IV- Temperature settings	
	a- I-temperature models (V059 - V159 - V259)	p. 16
	b- Multi-temperature models (S059 - S159 - S259)	p. 17
	V- Humidity level display	p. 18
	VI- Lighting mode adjustment	p. 18
	VII- Adjusting the display contrast	p. 18
	VIII- Carbon filter counter log display	p. 18
	8 • ALARMS	
	I- Temperature	p. 19
	II- Open door	p. 19
	III- Relative humidity level	p. 19
	IV- Carbon filter	p. 20
	9 • STANDARD MAINTENANCE	p. 20
	10 • OPERATING FAULTS	
	I- Temperature	p. 20
	II- Hot and cold circuits	p. 21
	III- Temperature probes	p. 21
	IV- Frost prevention device	p. 21
	V- Lighting	p. 21
	11 • TECHNICAL SPECIFICATIONS	p. 21
	12 • STORAGE LAYOUT EXAMPLES	p. 79



I - DESCRIPTION OF YOUR WINE CABINET

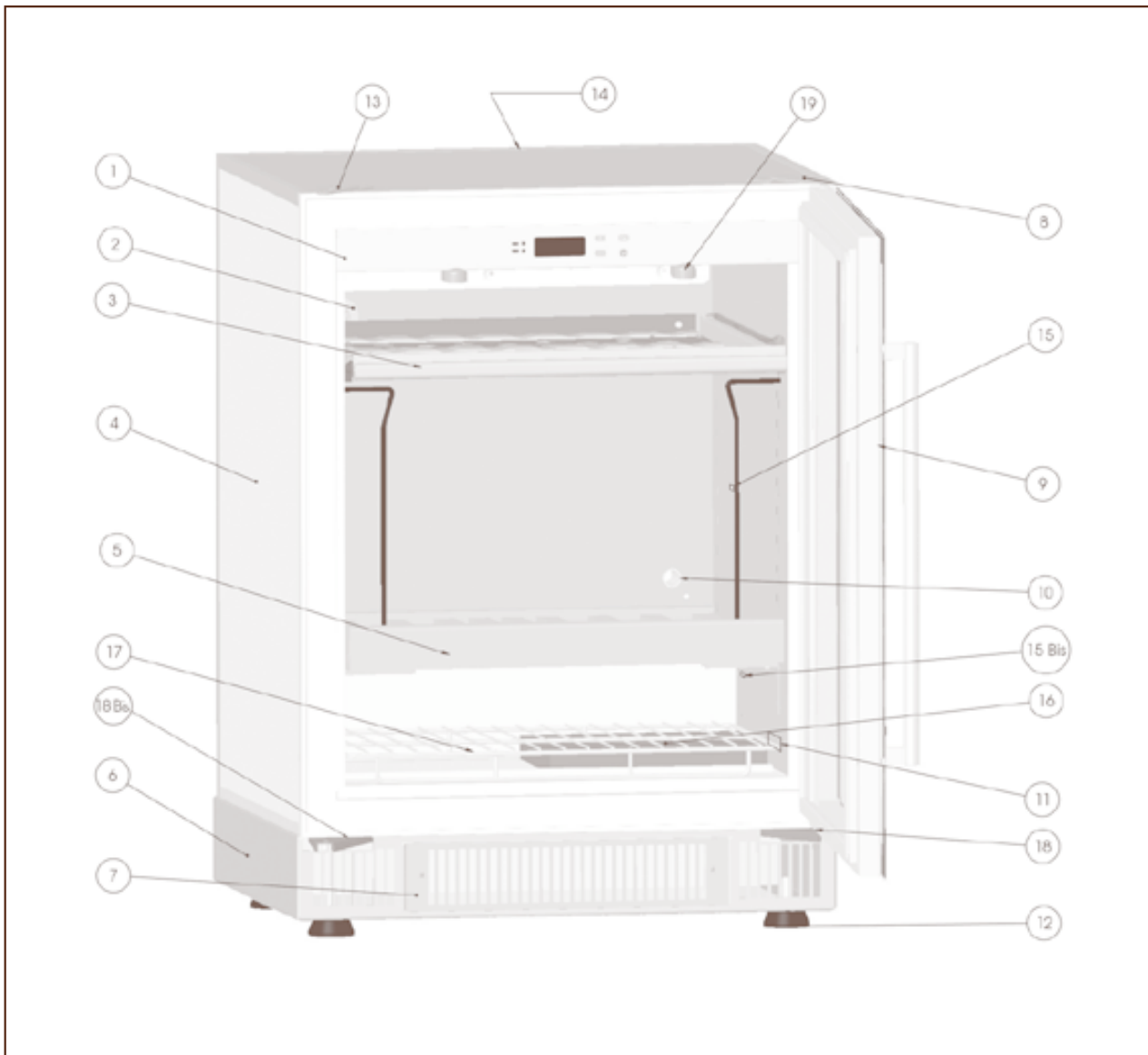

- 1 - Control and adjustment panel
- 2 - Air circulation hole + Active carbon filter
- 3 - Sliding shelf
- 4 - Cabinet case
- 5 - Storage shelf
- 6 - Base with front ventilation
- 7 - Filter access grille
- 8 - Upper hinge
- 9 - Door and handle
- 10 - Free air circulation hole
- 11 - Specification label

- 12 - 4 adjustable levelling feet
- 13 - Lug for fixing to work surface (if flush fitted)
- 14 - Anti-tilt system (for medium and large models)
- 15 - Location of temperature probe in 1 temperature models
- 15bis - Location of temperature probe in multiple temperature models
- 16 - Humidity cassette (1 temperature models)
- 17 - Grid
- 18 - Lower hinge + removable door pin
- 18bis - Lower hinge
- 19 - Light (2 leds)

2 - IMPORTANT SAFETY RECOMMENDATIONS



Caution

When using your wine cabinet always take certain basic precautions, especially:

Only use your wine cabinet for its intended purpose as described in this manual.

Never disconnect the wine cabinet by pulling on the power supply lead. To remove the plug, grip it firmly and pull in a straight line.

Do not use a power lead that is frayed or showing signs of wear. Have any damaged power lead replaced immediately.

Do not allow children to climb, sit on, stand on or hang from the shelves of the wine cabinet. They could damage the wine cabinet and cause themselves serious injury.

If the door has a lock, take care to keep keys out of reach of children in order to avoid them locking themselves in the cabinet.

NB : If the door has a lock, to ensure optimum safety, the wine cabinet is fitted with a double movement lock. To open or close the door, you must push, then turn the key while keeping it pressed (see diagram opposite).

 Never damage the refrigeration system of the unit.

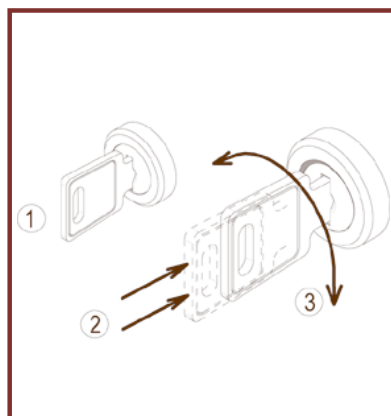

3 - POWER SUPPLY



For your personal safety, the wine cabinet should be properly earthed.

To avoid all risk of electric shock, the wine cabinet's power supply lead is fitted with a plug designed to fit into a standard earthed socket.

Have the power supply socket checked by a qualified electrician to confirm that it is earthed, and, if necessary have the work done to bring it into compliance.

If the power supply lead is damaged obtain a new one from your usual EuroCave dealer.

The power lead should be replaced by an original manufacturer's part.

IMPORTANT: any intervention should be carried out by a qualified electrician.

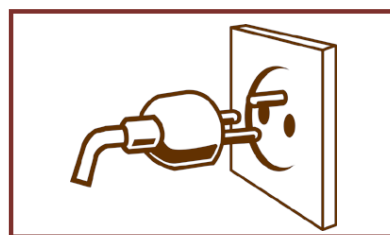

Make sure that the plug is earthed and that the installation's circuit is protected by a 30 mA* fuse.

*not applied to certain countries

4 - ENVIRONMENTAL PROTECTION AND POWER SAVING



Disposal of packaging:

The packaging components used by EuroCave are made out of recyclable materials.

After unpacking your cabinet, take the discarded packaging, the majority of which is recyclable, to a refuse collection point.

To comply with environmental protection legislation, your wine cabinet does not contain C.F.C gases.

Power saving:

- Install your cabinet in an appropriate location (see page 7) which provides the recommended ambient temperature ranges.
- Do not keep the door open any longer than necessary.
- Make sure that the door seal is not damaged and seals correctly. Contact your EuroCave dealer if damaged.

N. B.: Respect the environment: when replacing your wine cabinet, enquire about your local waste disposal services and use the correct recycling procedure.

Some substances and parts contained in EuroCave wine cabinets, particularly the refrigeration gases, use recyclable materials that require special disposal procedures.

If the door has a lock, remove the lock so that children cannot become trapped inside the cabinet.

Disable non operable appliances and disconnect and cut the power lead into short lengths.





5 - INSTALLING YOUR WINE CABINET

I - In General

- On unpacking your wine cabinet after delivery, check for any obvious exterior damage (dents, malformation, etc.).
 - Open the door and check that the inside of the appliance is complete and in good condition (walls, shelves, hinges, control panel, etc.).
 - In the event of a problem, contact your dealer.
 - Move your wine cabinet to your selected location. This position must be:
 - away from any heat source
 - not too wet (wash room, utility room, bathroom, etc.)
 - be on a flat solid floor
 - have an electrical power supply (standard 13A plug connected to a 30 mA circuit breaker)
 - Never place your wine cabinet in a location liable to flooding.
 - Avoid splashing water onto the base of the appliance.
 - Place the clay humidity cassette (for I temperature models only), which you will find inside your cabinet's "accessories" box) in the receptacle provided for it beneath the grid located at the base of the cabinet (see diagram page 19). When using the cassette for the first time, please soak the cassette for ten minutes in water, and let it drain.
 - Take the power lead (which you will find inside your cabinet's "accessories" box) and connect it to the socket provided at the rear bottom left of the cabinet.
 - Unwind the power supply lead so that it can be accessed.
 - Place the power supply lead so that it is not in contact with any of the appliance's components.
 - **IMPORTANT - Wait 48 hours before switching on to allow the fluids contained in the internal circuits to settle.**
 - Adjust the 4 feet of the cabinet (by screwing in or out), so that your wine cabinet stands perfectly level (we recommend using a spirit level).
 - Never obstruct the front ventilation grille.
 - Remove the protective packing inside the cabinet.
 - Install the carbon filter, which you will find inside your cabinet's "accessories" box, by placing it in the air circulation hole located inside the cabinet on the top left hand side (see diagram opposite).
 - For medium and large models, if the wine cabinet is not free-standing, it is **essential** to secure it to the wall to prevent it from tipping forward.
- You will find all the necessary parts in the accessories bag supplied with the unit.
- For installation (see diagram opposite):
- 1- Attach the bracket (1) to the cabinet with the screws (2)
 - 2- Clip the nut (3) to this bracket (preferably choose the hole nearest to the cabinet)
- WARNING:** make sure that the part is correctly clipped by pulling upwards by hand. The clip must not come out
- 3- Preposition the wall bracket (1') (on the nut (3)) to determine the position for drilling the holes for the wall-mounting screws
 - 4- Drill the holes then attach the wall bracket (1') with (4) suitable screws
- WARNING:** ensure that the wall fixing can withstand a tensile force of 100 kg
- 5- Tighten screw (6) with the washer (5) until it is screwed fully in and there is contact between the wall bracket (1') and the nut (3).
- Only full tightening of the screw will ensure correct fixing of the unit.

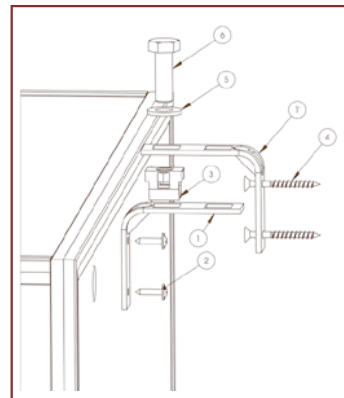
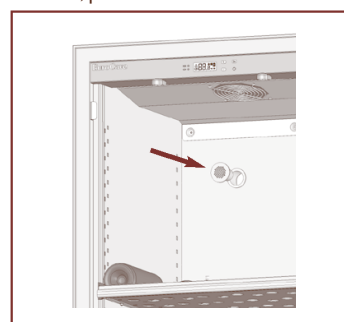

- 1 - fixing bracket (x2)
- 2 - screw for fixing to cabinet (x2)
- 3 - clipped nut
- 4 - screw to suit wall fixing (not supplied)
- 5 - washer
- 6 - fixing screw

N.B.: when moving your wine cabinet, do not incline it more than 45°, and always toward side where the power lead is located.

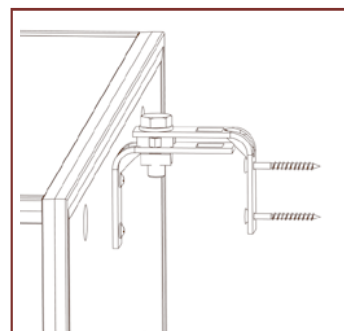

5 - INSTALLING YOUR WINE CABINET



II - Building in and reversibility

a - Summary of parts

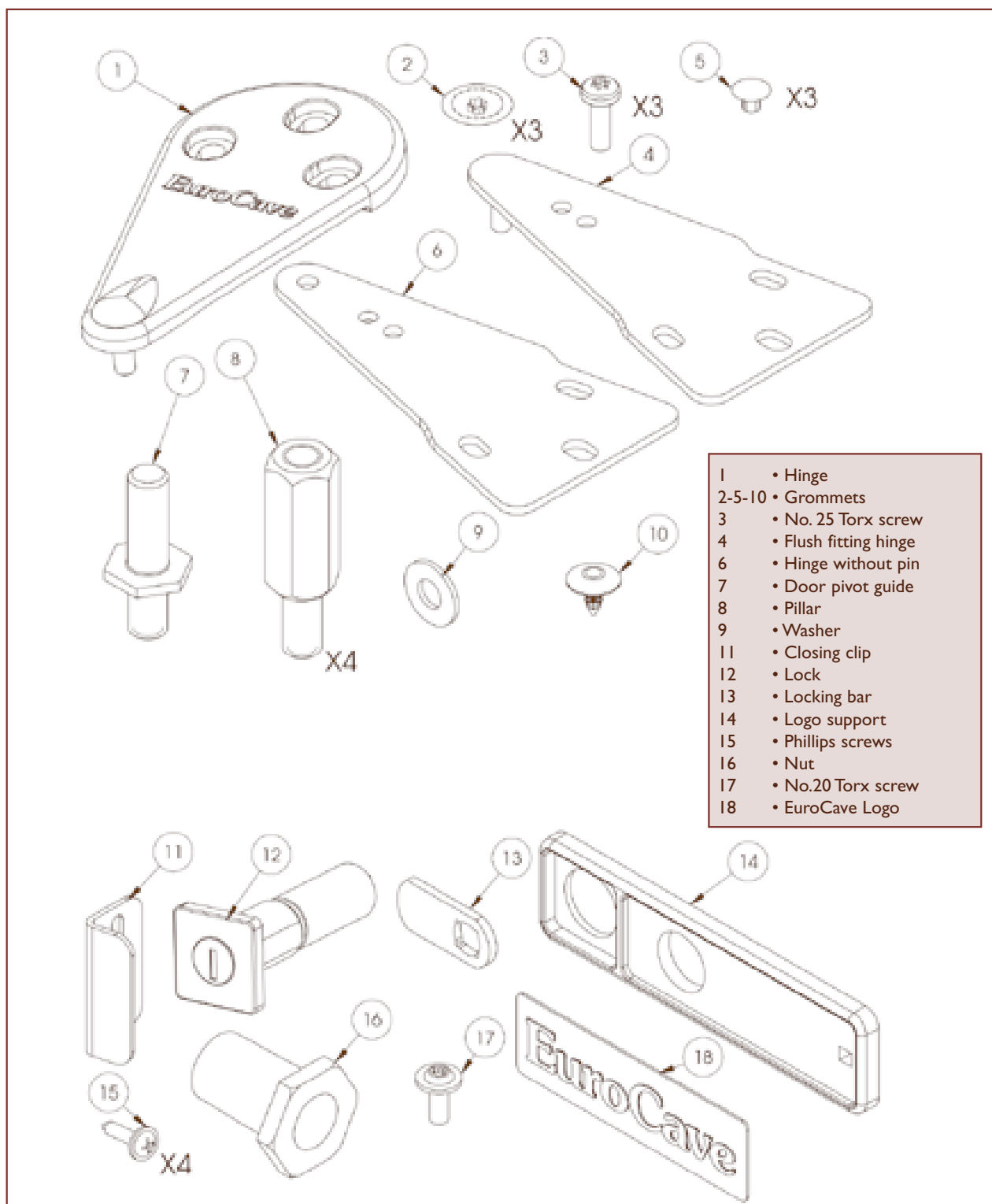



5 - INSTALLING YOUR WINE CABINET

b - Building in

- Dimensions for solid or glass door (Fig. 1) :

	A maxi	A mini	B	C mini
059	831	815	Solid door 552 Glass door 540	820
159	1231	1215	Solid door 552 Glass door 543	1220
259	1791	1775	Solid door 552 Glass door 543	1780

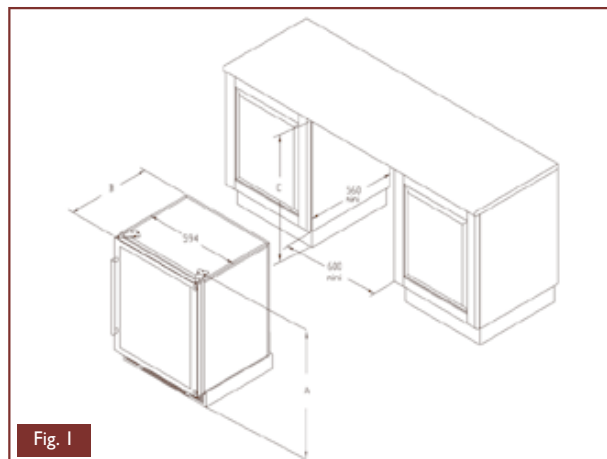

Fig. 1

- Dimensions for a technical door (Fig. 2) :

	A maxi	A mini	B mini
059	852	836	841
159	1252	1236	1241
259	1812	1796	1801

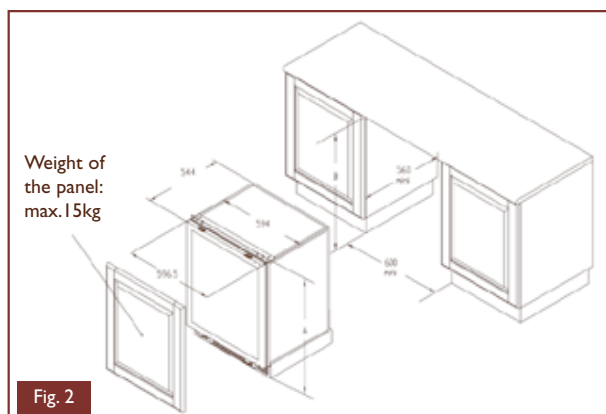

Fig. 2

- Changing the hinges

- Remove the plugs (2) and screws (3) with a T25 Torx screwdriver and lift off the hinge (1) (Fig. 3).

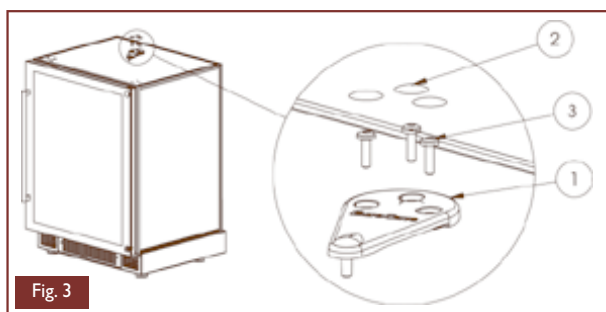

Fig. 3

Precautions :

If you lift off the glass door of the cabinet, never place it on its edges which may cause it to break (Fig. 4).

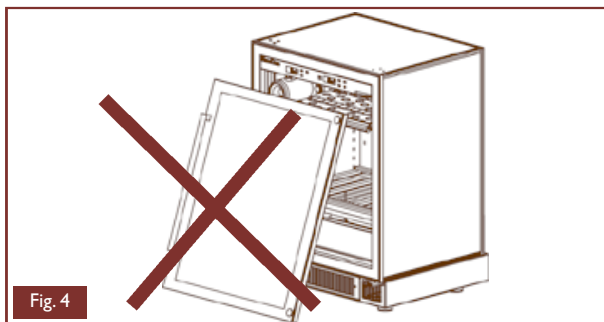

Fig. 4

- Fit the hinge with pin (4) using the screws (3) so that the door is parallel to the cabinet (Fig. 5).

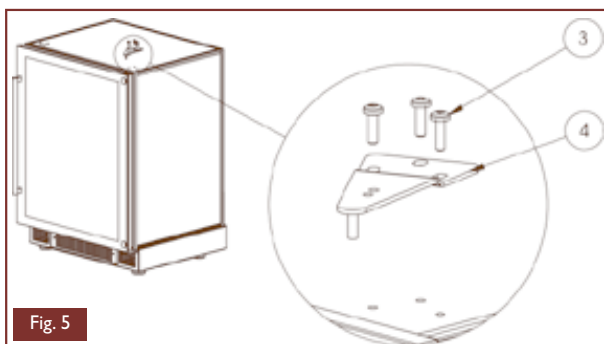

Fig. 5

Precautions : When closing the door, check that the seal adheres correctly to the cabinet so that it is airtight.

Remove plugs (5) (Fig. 6).

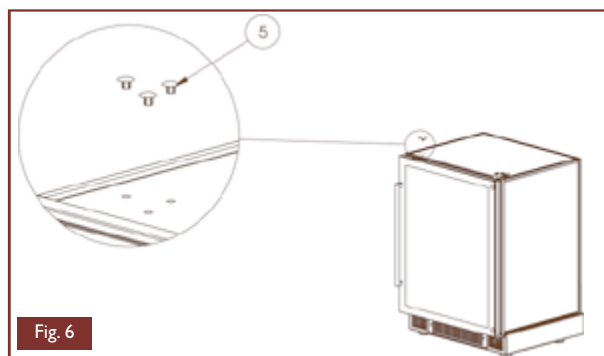

Fig. 6

- Fit the hinge without pin (6) with the screws (3) (Fig. 7).

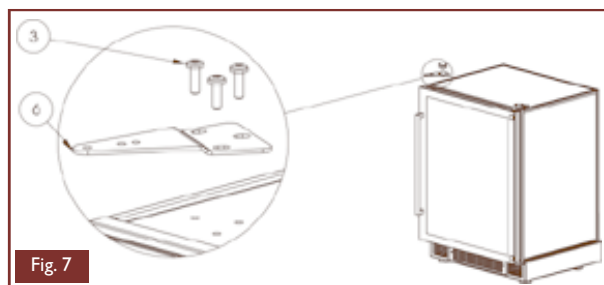

Fig. 7

5 - INSTALLING YOUR WINE CABINET



• Adjusting the mounting feet and attachment (only when the cabinet is empty)

- The 4 feet of the wine cabinet are adjustable in height so that the height below the work surface or in the unit can be adjusted, and to align the door with adjacent furniture (Fig. 8).

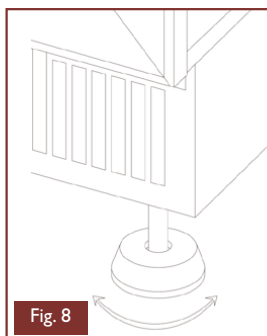

- If necessary, use the hexagonal pillars (8) (Fig. 9) that you will find in the "accessories" bag. Tilt the unit forward, taking care to keep the door closed.

Unscrew the rear feet and install the pillars, using a 17 mm flat spanner

Screw the 2 rear feet back onto the pillars

Repeat these operations for the 2 front feet, taking good care to tilt the unit backwards.

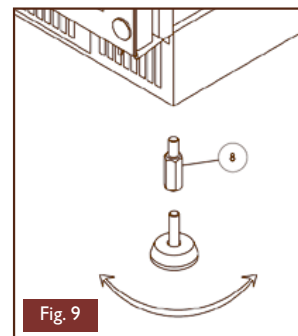

- Use the correct screws to secure the wine cabinet under the work surface or in the unit through the holes provided in the hinges.

Never obstruct the front ventilation grille which would impair the operation of the wine cabinet (Fig. 10).

Precautions : on the side of the axis of rotation of the door, position the latter a minimum of 3 mm from adjacent furniture.

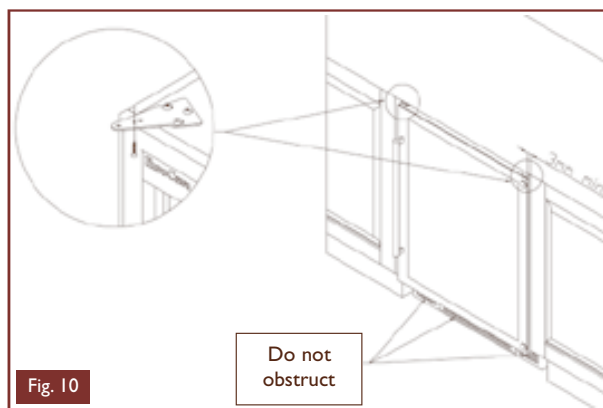

The mains power socket must be accessible after installation of the unit.

For medium and large models, it is **essential** to secure the cabinet to the wall to prevent it from tipping forward. Have your cabinet checked by a professional to confirm that it is fixed to the furniture and that the furniture is fixed to the wall.

Attachment of a furniture door with a technical door:

- Position the cabinet level under the work surface or in the furniture.
- Open the cabinet door 90°.
- Fix the facing of the kitchen furniture to the cabinet door 98 screws supplied).
- Check that the seal is airtight.

Installing a cabinet within a high level kitchen unit



For safety reasons, we do not advise installing the wine cabinet in a kitchen unit.

If this is the case, check with a furniture specialist that the unit supporting the equipment and the surrounding furniture can support the weight of the cabinet when filled with full bottles, or 200 kg. Have its stability checked when opening the door and removing shelves loaded with full bottles.

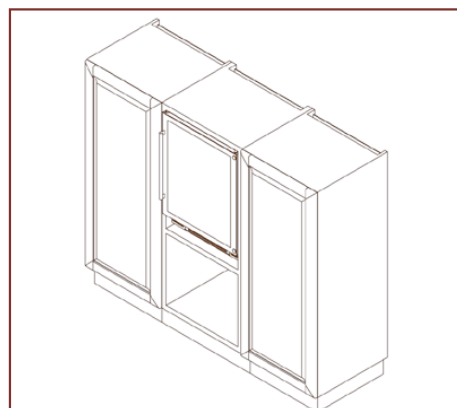



5 - INSTALLING YOUR WINE CABINET

c - Reversibility of the door

The door of the wine cabinet is reversible so you can change the direction of opening.

To do this, proceed as follows (for example, to change a right hand door into a left hand door):

- Close the door
- Carefully remove the plugs (2) and (5) with a thin blade (Fig. a)
- Unscrew the screws (3) with a Torx screwdriver while holding the door to prevent it falling (Fig. a)
- Remove the upper hinge (1) (Fig. a).



- Lift the door off the cabinet by opening it slightly, then lifting it up (Fig. b).

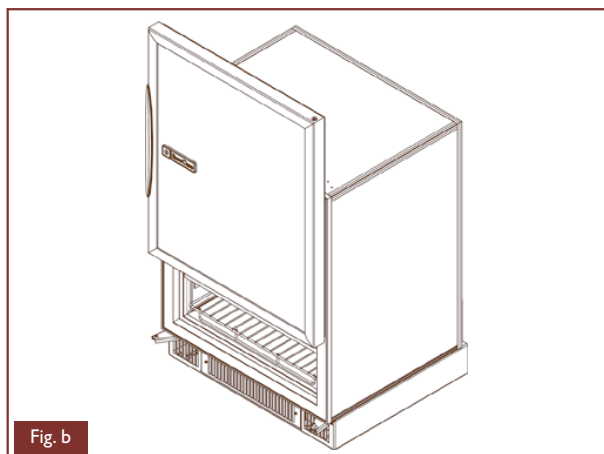

- Remove the washer (9), remove the pin (7) with a no. 10 hexagonal spanner (Fig. c)
- Carefully remove the plug (10) with a thin blade and in its place fit the pin (7) and washer (9) (Fig. c)
- Replace the plug (10) on the opposite side (Fig. c).

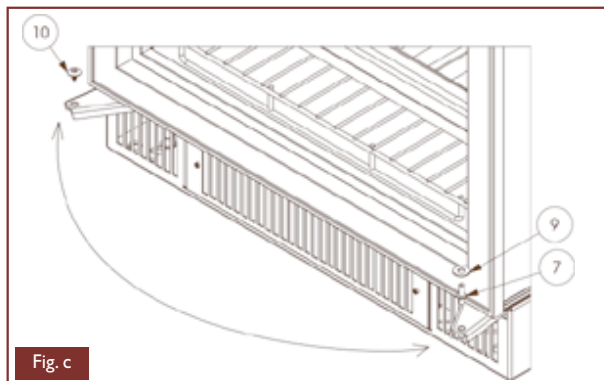

- Unscrew the 4 screws (15) (Fig. d)
- Attach the lug (11) to the opposite side of the cabinet, using the screws (15) (Fig. d).

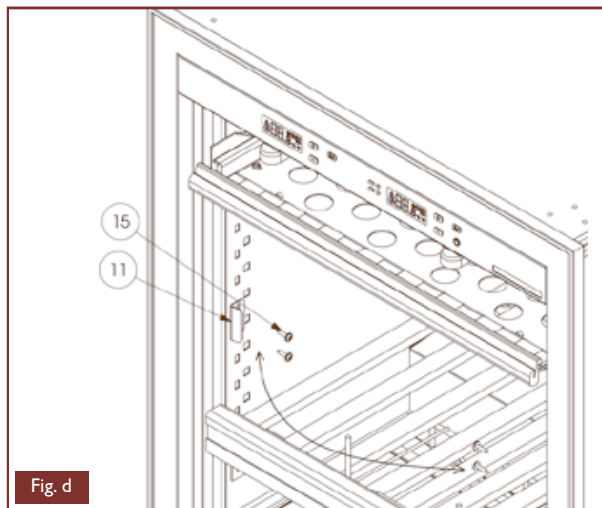

Then turn the logo round (solid doors only)

- Unscrew the screw (17) with a 25 Torx screwdriver (Fig. e)
- Remove the cam (13) (Fig. e)
- Unscrew the nut (16) with a no. 28 spanner (Fig. e).

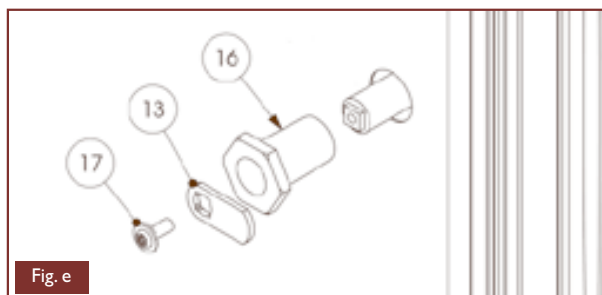

- Remove the lock (12) while holding the logo support (14) (Fig. f).

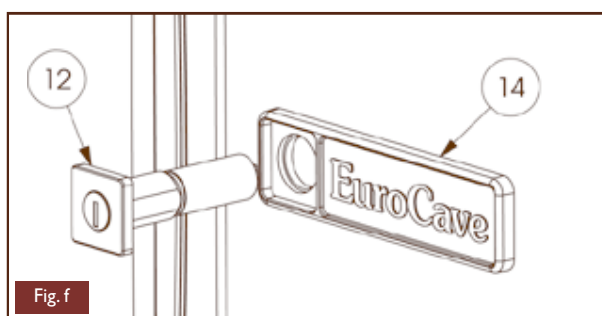

- Taking care, transfer (to the lock side) the logo support (14) (Fig. g).



5 - INSTALLING YOUR WINE CABINET



- Remove the logo support (14) (Fig. h).



- Gently press the "EuroCave" logo (18) to loosen it from the logo support (14) (Fig. i)
- Rotate the logo (18) 180° before repositioning it on the logo support (14) (Fig. i).

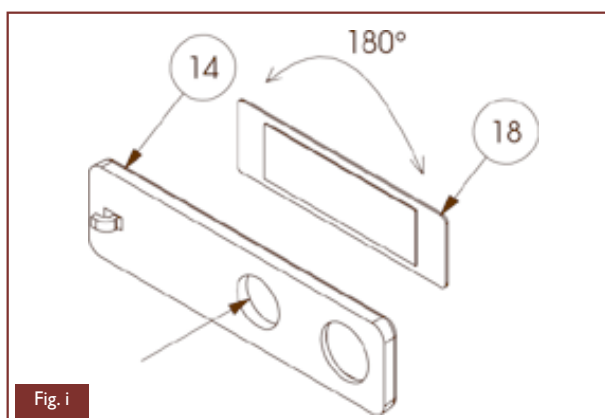

- Turn the door through 180°
- !!! WARNING: the glazed doors are very heavy. Take all necessary precautions not to injure yourself or drop the door. Never place it on its edges, which may break it.
- Replace the logo support (14) (Figs. g and h).
 - Replace the lock with the slot vertical and pointing downwards (Fig. j).

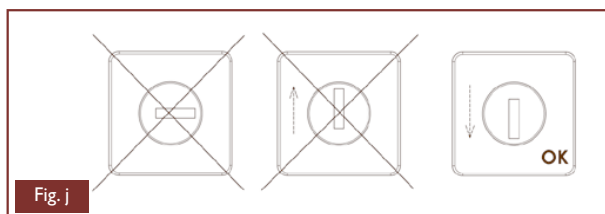

- Tighten the plastic nut (16) first by hand as far as possible, then with a 28 spanner (maximum 1/2 turn of the spanner)
- Attach the cam (13) to the end of the lock (12) with the screw (17) and with a "TX20" Torx spanner supplied in the accessories bag (Figs. k and e)

!!! WARNING note the direction of rotation of the cam (13): it must always turn upwards (whether the door is mounted on the right or left side).

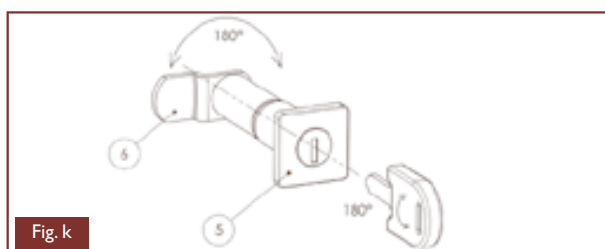

!!! WARNING: for safety reasons, the key has a double action: it must be pressed and turned at the same time (Fig. l)

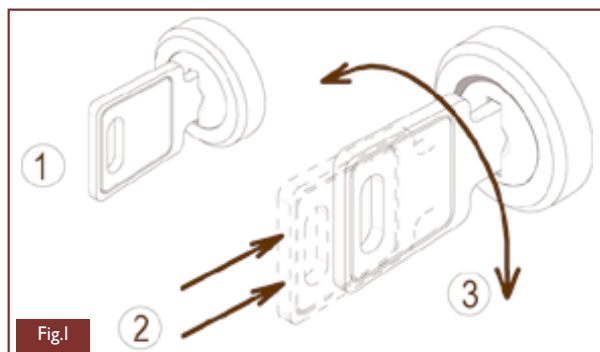

- Reposition the door vertically on its axis (7) not forgetting the washer (9) (Fig. m).

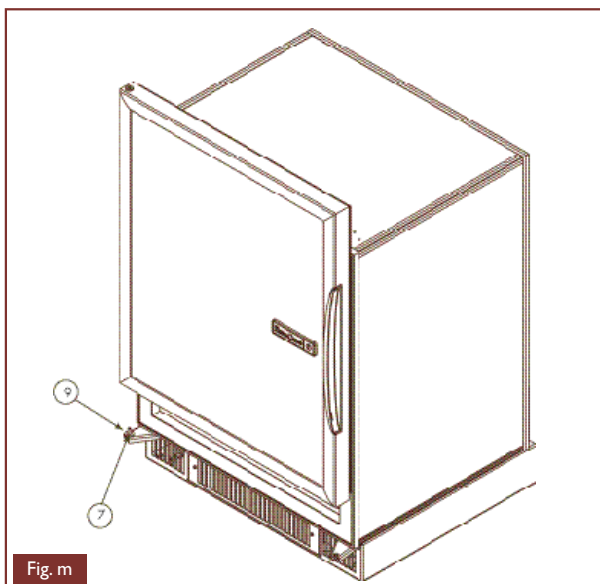

- Reattach the hinge (1) with the screws (3) so that the door is parallel with the cabinet (Fig. n)
 - Check that the seal adheres to the cabinet (by closing the door), to make it airtight
- !!! WARNING: maintain the distance X between the door and the cabinet (X = 11 mm for the glazed door of the small model and X = 10 mm for all other models).
- Insert the plugs (2) and (5) (Fig. n).

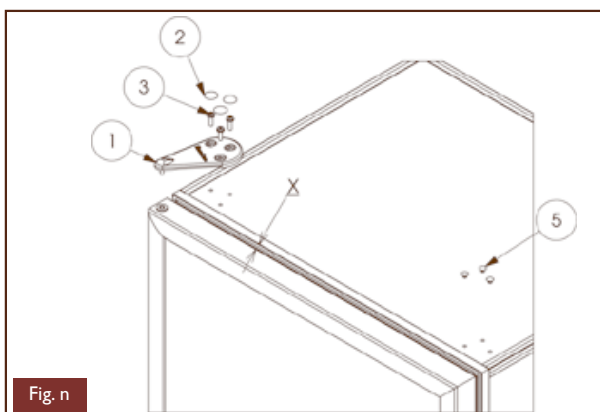

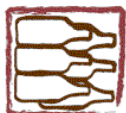







6 - ARRANGEMENT AND STORAGE

Your EuroCave wine cabinet has been designed to evolve. Depending on the model, it can be adapted to your requirements and be modified in terms of storage:

I - Various storage methods

	Universal storage shelf Ref: AXLN Capacity: 50 bottles Max. weight: 85 kg		Universal slatted sliding shelf Ref: ACUPC Capacity: 8 bottles		Service Kit Ref: ACLK Capacity: 33 bottles with 6 vertical
	Universal matted sliding shelf Ref: AXMU Capacity: 8 bottles		Optional presentation for ACUPC Ref: ACOP Capacity: 9 bottles with 5 inclined		Bar sliding shelf Ref: ACOK Capacity: 29 bottles with 6 vertical

How to use the storage shelf (Ref. AXLN)



To store bottles of **Bordeaux**: Turn each metal rod so that it is in contact with the wall of the cabinet. Storage for 4 rows at the front and 5 rows at the back, or 50 bottles*.

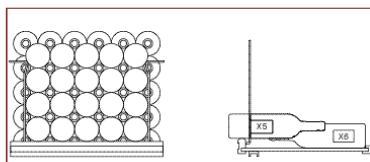

* Each shelf is fitted with a label holder. (p. 33)

To store bottles of **Burgundy**: Remove the metal rods. Storage on 7 levels, 8 bottles on each level, or 56 bottles*.

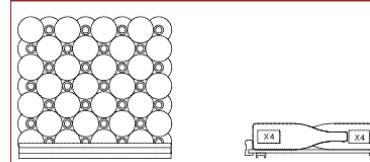

The layout of your wine cabinet can be modified according to your requirements. Refer to pages 79 to 82 to look at arrangement examples

II - Advice on arranging your wine cabinet

Your EuroCave wine cabinet has been designed to store a maximum number of bottles in total safety. We recommend that you abide by the following few suggestions in order that the maximum storage capacity can be obtained.

- Make sure that you distribute your bottles as evenly as possible onto the various shelves contained in your cabinet so as to spread the weight equally. Also take care that your bottles do not touch the cabinet's rear wall.
- Make sure you distribute your bottles evenly throughout the height of the wine cabinet (avoid loading all bottles at the top or all bottles at the bottom).
- Be sure to observe the storage recommendations in accordance with the type of storage facility provided by your cabinet. Never stack more than one layer of bottles on a sliding shelf.
- If you have sliding shelves, for easy day to day access it is a good idea to place them in the upper part of your wine cabinet.

- **For this reason, place one or two bottles of each of your various wines on the sliding shelves and your reserve stock on the storage shelves. Then all you have to do is top them up as required.**
- **When using your wine cabinet, never pull out more than one sliding shelf at a time.**

WARNING: Never modify the position of your wine cabinet's bracing bar without first consulting your dealer, and never manoeuvre this part when the cabinet is stocked (only for I59 and 259 models).

III - Adding sliding shelves

When you purchase your wine cabinet, the dimensions of the sliding shelves have been adjusted so that they fit perfectly into the interior of your cabinet. In the event that you purchase another sliding shelf, if necessary, you can adjust it yourself. To do this, loosen the right and left screws of the first slider (2 screws), then adjust the slide to the width required and retighten the screws. Repeat the procedure for the second slider (if required):

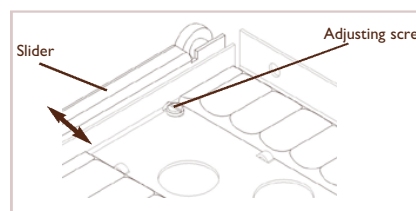
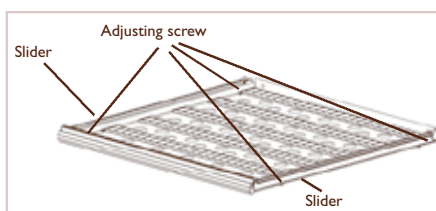

6 - ARRANGEMENT AND STORAGE

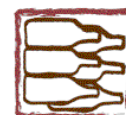

IV - Modifying the layout of your cabinet

To change the position of a storage shelf, you must first of all unload the shelf, then remove the shelf supports taking care to reinstall them as shown opposite:

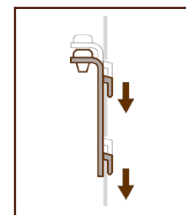
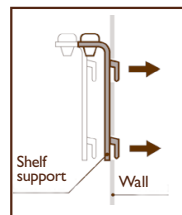

To change the position of a sliding shelf, you must first of all completely unload it. Then lift out the sliding tray by sliding it forwards whilst at the same time lifting it from the front. Find the runner guides on the left and right and remove. Then reinstall them in the new position as shown below:

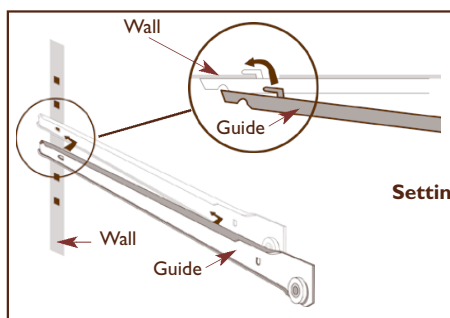

Setting up the rear part of the guide

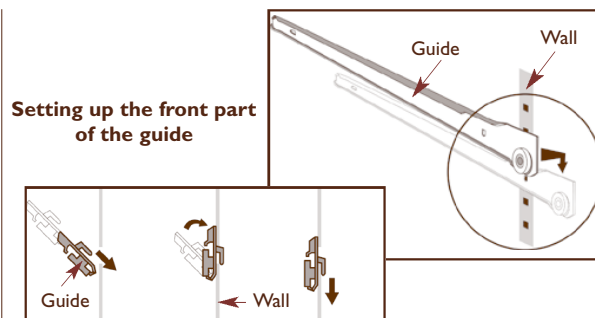

Setting up the front part of the guide

Then replace the sliding drawer as shown opposite:

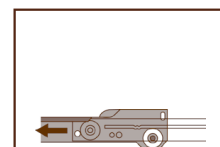
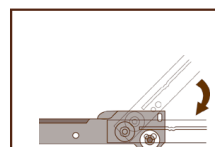
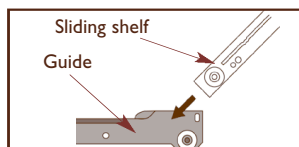

7 - COMMISSIONING YOUR WINE CABINET



I - Connecting up your wine cabinet

Make check that your socket has a power supply (presence off fuses and amperages, and that there is an operational 30 mA circuit breaker*).

* Not applied to certain countries.

Having waited for 48 hours, switch on your wine cabinet at the main power supply

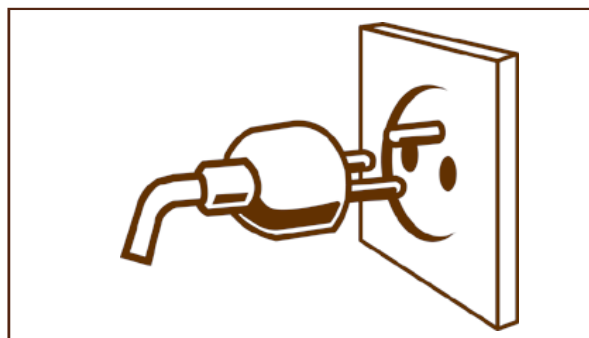

II- Switching on the cabinet

Press on the internal  and standby button and then release. A start-up message flashes for 5 seconds before the cabinet's temperature is displayed. At the time of switching on, if the set temperature is less than the ambient temperature, the blue cold circuit indicator will light up.

If the set temperature is higher than the ambient temperature, the red hot circuit indicator will light up.

To put your cabinet in standby, press on the  button for 5 seconds.



7 - COMMISSIONING YOUR WINE CABINET

III - Control panel description

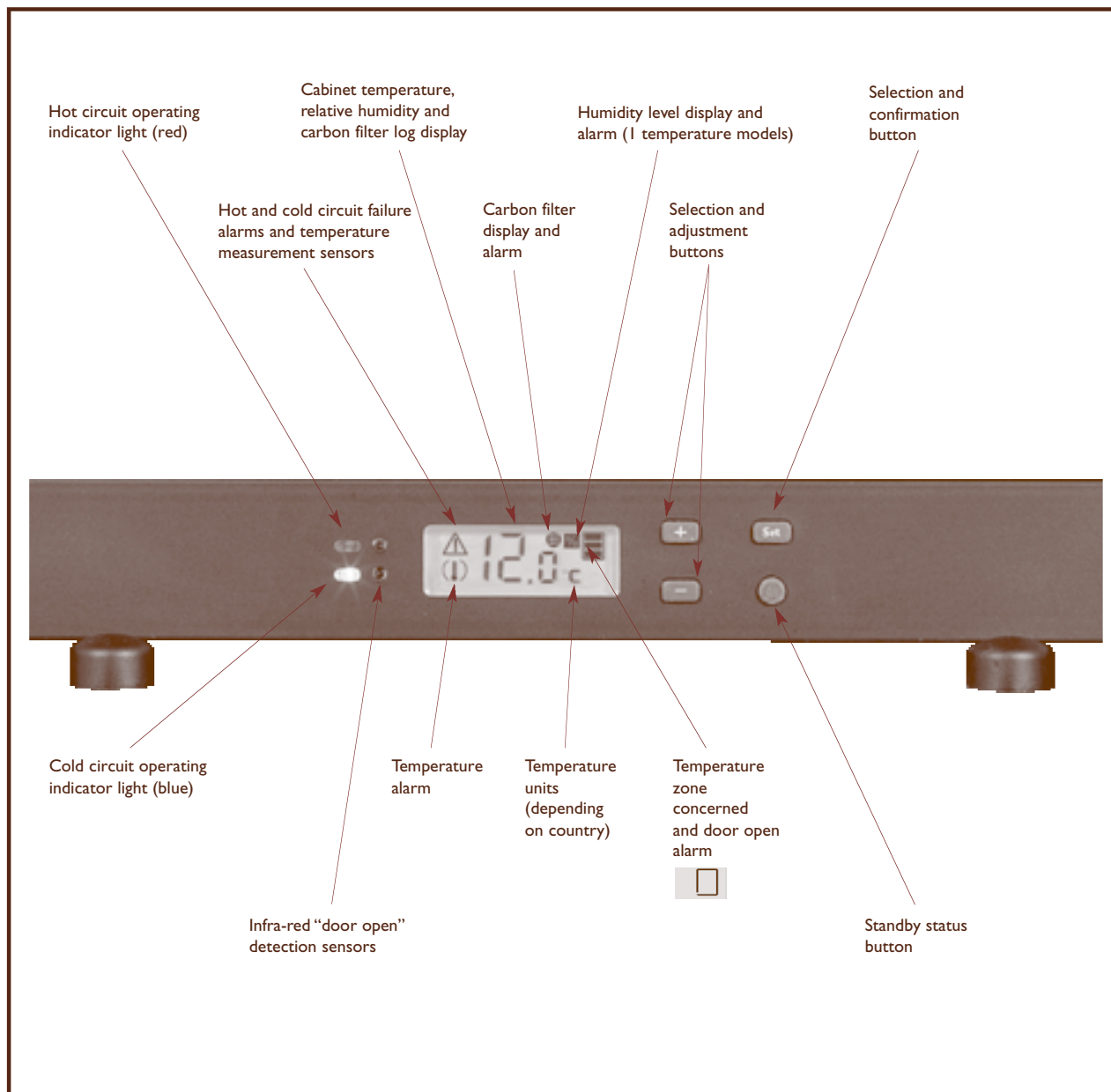

Did you know?

Contrary to popular belief, all, red, white or sparkling wines can be preserved at a temperature of between 10° and 14°C. If wine is subjected to violent heat variations, it will "dilate" then "contract". Such variations create fatigue in the wine, alter its organic vitality and lead to a loss in quality. For further information on the temperatures for serving wine, please refer to the table on page 3.

7 - COMMISSIONING YOUR WINE CABINET



IV - Temperature settings

a- I-temperature models (V059 - V159 - V259)

Your wine cabinet's temperature is adjusted at the control panel which contains the following features:

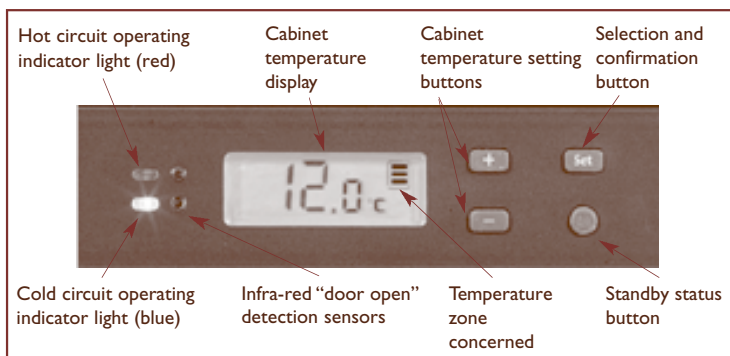

- Temperature display: displays the actual temperature inside your wine cabinet
- Adjustment buttons: enables the required temperature inside the cabinet to be selected
- Indicator lights: display the operational status of the hot (red) and cold (blue) circuits

To adjust the temperature of your I-temperature cabinet:

- Press the **Set** button and release it immediately

The current set temperature is displayed (the displayed figure flashes).

- When the displayed figure flashes you have 5 seconds to change the temperature setting

by pressing the **+** or **-** button as appropriate, otherwise the display automatically returns to the previous setting.



Recommended maturing setting range: 10 to 14°C (50° to 57°F)

- Press the **Set** set button to confirm the new setting and the display will show the new setting.

The default setting is 12°C / 54°F (ideal maturing temperature). However, this setting can be adjusted between 5 and 20°C* (41° and 68°F*).

Beyond these limits, the buttons **+** and **-** are disabled.

*Converting your maturing cabinet into a service cabinet

You can use your I-temperature maturing cabinet as a service cabinet in order to bring your white and red wine to tasting temperature (setting range between 5° to 20°C / 41° to 68°F).

- White wines: recommended setting between 6° to 10°C (43° to 50°F),

- Red wines: recommended setting between 15° to 18°C (59° to 64°F).

This cabinet can therefore be used as a specific white or red wine service cabinet.

WARNING: to operate correctly your cabinet should be located in a room with a temperature between 0° and 35°C (32° and 95°F)

When making substantial changes to the temperatures it may take several hours to stabilise and display the required temperature.



7 - COMMISSIONING YOUR WINE CABINET

IV - Temperature settings

b- Multi-temperature models (S059 - S159 - S259)

Your wine cabinet's temperature adjustment is carried out using the control panel which contains the following features:

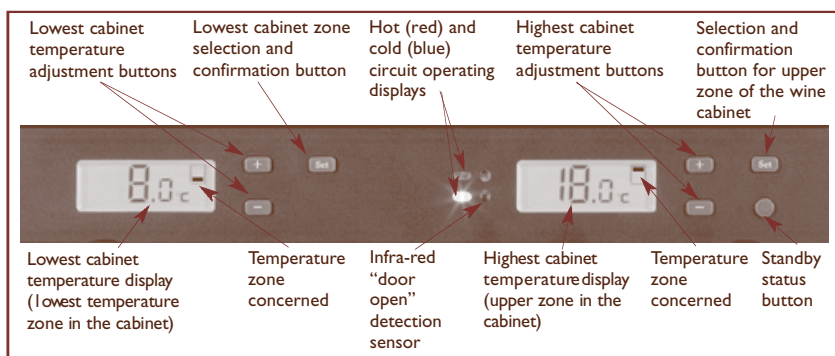

- Temperature display: displays the actual temperature inside your wine cabinet
- Adjustment buttons: enables the required temperature inside the cabinet to be selected
- Indicator lights: display the operational status of the hot (red) and cold (blue) circuits

To adjust the temperature of your multiple temperature cabinet:

- Carry out the same procedure as for adjusting the temperature setting of the 1 temperature model.

Recommended setting range for the lowest temperature: 7 to 12°C (45° to 54°F)

Recommended setting range for the highest temperature: 15 to 21°C (59° to 70°F).

The default setting for the lowest temperature range is 8°C (46°F).

However, this setting can be adjusted between 5 and 12°C (41° and 54°F).

Beyond these limits, the buttons  and  are disabled.

The default setting for the highest temperature range is 18°C (64°F).

However, this setting can be adjusted between 15 and 22°C (59° and 72°F).

Beyond these limits, the buttons  and  are disabled.

WARNING: to operate correctly your cabinet should be located in a room with a temperature between 12° and 35°C (54° and 95°F).

When making substantial changes to the temperatures it may take several hours to stabilise and display the required temperature.

Did you know?

A wine cabinet must be designed in such a way that bottles do not come into contact with the rear wall. In some circumstances, condensation created on the rear wall can trickle down onto the shelves and damage the bottle labels. Also, contact with a cold wall can create a frost point which is harmful to the wine.

7 - COMMISSIONING YOUR WINE CABINET



V- Humidity level display

Your wine cabinet is equipped with a hygrometry function (I-temperature models set between 9°C and 15°C / 48° and 59°F), enabling you to see the relative humidity level inside the cabinet. The ideal hygrometry rate is over 50%.

- Press on the button * for 5 seconds
The relative humidity is displayed (from 50% to 90%).

After 15 seconds the display will automatically return to cabinet temperature.

Should you wish to increase the level of relative humidity inside your cabinet, pour the equivalent of one glass of water on the clay humidity cassette in the receptacle located at the bottom right hand side of your cabinet (see diagram on next page "Relative humidity level alarm").



VI- Lighting mode adjustment

Your wine cabinet has mood lighting that also enables you to read your wine labels more easily.

Unlike standard lighting, EuroCave lighting does not produce ultraviolet rays, and only gives off a miniscule amount of heat.

Thus, your wines are preserved in total safety

Electrical consumption less than 7 watts / hour in constant use.

Usage precautions:

Intense light, never look directly into the beam.

There are two possible lighting settings:

-  - lighting when door opens (it goes out when the door is closed),
- lighting all the time (for mood lighting when using a glass door cabinet, for example).

- Press on the button * for 5 seconds, the lighting mode is then displayed.

- Press on the button * to select your lighting mode (two options):

Example of a display for I-temperature model

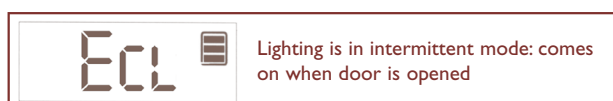

Lighting is in intermittent mode: comes on when door is opened



Lighting is in constant mode



- Press on the button * to confirm your choice and move on to the next step (setting display contrast)

Note: When "Ecl" is displayed, you have 15 seconds to select and confirm the required lighting mode, otherwise the display automatically returns to cabinet temperature.

VII- Adjusting the display contrast

You can increase or reduce your cabinet's display contrast:

Once you have confirmed the lighting mode, "LU n" appears:

- Press on the buttons  or * to increase or reduce your cabinet's display contrast
- A figure of 0 to 7 is displayed after the "LU" (0 being the least contrast, and 7 the most).

- Press on the button * button to confirm your choice and move on to the next step (display of the carbon filter log)

Note: When "LU n" is displayed, you have 15 seconds to select and confirm the required lighting contrast, otherwise the display automatically returns to cabinet temperature.



VIII- Carbon filter counter log display

Your wine cabinet has a counter that displays the number of days that the carbon filter has been in use (change once a year, see current maintenance chapter page 20)

After setting the display contrast, the counter is displayed, as in the following example:

- The display here shows that the filter has been operating for 28 days

After 15 seconds the display will automatically return to cabinet temperature, or press on the * button.



* For multi-temperature models, the buttons are located to the right of the casing.



8 - ALARMS

Your wine cabinet has several alarms

A signal warns you if:

the temperature inside the cabinet exceeds the set temperatures

the door has been left open or is badly closed

- the relative humidity level is too low (I-temperature models set between 9 and 15°C / 48° and 59°F)

- the carbon filter needs changing

In this way your fine 'crus' are secure.

I- Temperature

If your cabinet's temperature stays at + or - 4°C (7°F) in relation to the set temperature for more than 24 hours, a visual and sound alarm is triggered.

The icon  flashes and a sound signal alerts you.

- The sound alarm cuts out if one of the buttons is pressed  or *.
- However, the icon stays displayed until the temperature has returned within the limits of + or - 4°C (7°F).

The alarm can trigger in the following circumstances:

- The door has been left open or is badly closed:

the open door alarm (see next chapter) will trigger, and if you do not close the door the temperature within the cabinet will exceed the limits and the temperature alarm will also trigger.

Close the door and wait a few hours until the temperature inside the cabinet has stabilised, the icon will then disappear.

- The door seal is damaged:

the door sealing is degraded, and the temperatures may exceed the limits and trigger the alarm

Contact your EuroCave dealer

- You have loaded your cabinet with a large number of bottles:

it takes several hours for your cabinet to reach the right temperature, so the alarm may trigger.

This could happen when first starting up the cabinet, this is not due to an operating fault.

Wait a few days for the cabinet interior temperature to stabilise.

If however, after a few days, the alarm is still triggered, please contact your dealer.

Apart from these three cases, if the alarm triggers it could be the result of an operating fault (see next page)



Contact your dealer.

N.B. : Only **prolonged** exposure to temperatures outside the set range and temperature fluctuations can damage your fine 'crus'

II- Open door

If the door of your cabinet remains open for more than 15 minutes, a visual and sound alarm will trigger.

The icon  flashes and a sound signal alerts you.

- The sound alarm cuts out if one of the buttons is pressed,  or *.
- However, the icon stays displayed until the door is closed

Close the door: the icon will disappear after one minute

III- Relative humidity level

(I-temperature models used between 9°C and 15°C / 48° & 59°F)

If the relative humidity rate in your wine cabinet falls below 50% for more than 72 hours, a visual alarm is triggered

The  icon is displayed flashing

- The icon remains on display until the level of humidity rises above 50%

To return to a level of humidity of over 50%, pour the equivalent of a glass of water into the channel located at the bottom right of the cabinet . You need to remove the bottles before (see diagram opposite).

The hygrometry level rises to a suitable level, and after a few hours the icon will go out.

N.B: Only **prolonged** exposure to humidity rates of under 50% may prove harmful to your bottle corks.

*** For multi-temperature models the buttons are located to the right of the casing.**



8 - ALARMS



IV- Carbon filter

We recommend that you change the carbon filter in your cabinet every year (see current maintenance chapter)

When the filter has reached a lifespan of one year, the icon  will flash.

Once the carbon filter has been changed, go to the "carbon filter counter log" menu (see page 18) and reset the counter by pressing on the button .

The icon  will then go out.

9 - STANDARD MAINTENANCE



Your EuroCave wine cabinet is a tried and tested, easy-to-use appliance. The few following maintenance steps will enable you to achieve a very long appliance lifetime.

Clean the filter at least every 3 months, (see diagram opposite)

- Remove the 2 screws (1) from the grille with a no. 2 hexagonal spanner (not supplied)
- Remove the grille (2), take out the filter (3) and place under running water
- Leave to dry and refit the assembly.

- Each year, replace the active carbon filter housed in the upper ventilation hole in your cabinet.

Remove the carbon filter, if necessary using a screwdriver to lever it out (see diagram opposite). The carbon filter is available from your usual dealer. It must be replaced using a manufacturer guaranteed part.

A visual alarm will warn you when you need to change the carbon filter (see previous chapter).

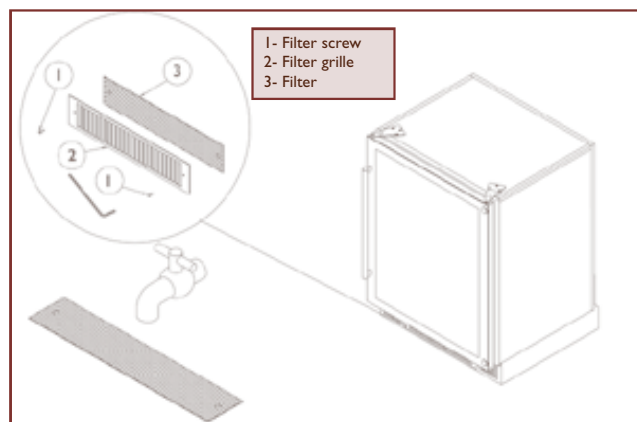

- When cleaning your cabinet, and before moving it, make sure that you have unplugged it and removed all the bottles from the cabinet.

- Carry out a complete cleaning of the inside of the cabinet once a year, after having unplugged and unloaded it (use water and a gentle cleaning product, then rinse carefully).

Monitor your appliance regularly and report anything that might appear abnormal to your dealer, in this way you can guarantee the long life of your cabinet.

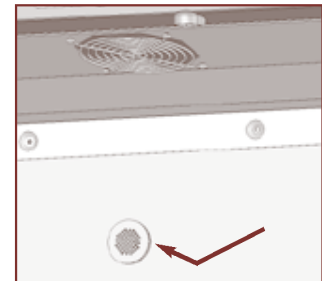

10 - OPERATING FAULTS



In the event of operating faults in your appliance, alarms will warn you of the type of problem encountered.

I - Temperature

If your cabinet's temperature stays at + or - 4°C (7°F) in relation to the set temperature for more than 24 hours, a visual and sound alarm is triggered.

The icon  flashes and a sound signal alerts you.

- The sound alarm cuts out if one of the buttons is pressed,  or .
- However, the icon stays displayed until the temperature has returned within the limits of + or - 4°C (7°F).

Check that (see temperature alarms chapter page 19):

- **The door of the cabinet is closed the door seal is not damaged**
- **You have not loaded a large number of bottles into your cabinet during the last few hours-**
- **Once you have checked these points, if the alarm continues for a few days, there may be an operating fault. In this case, please contact your dealer.**

N.B: Only **prolonged** exposure to excessive temperatures or violent fluctuations in temperature will harm your fine 'crus'.





10 - OPERATING FAULTS

II- Hot and cold circuits

In the event of a fault in the hot/cold circuits:

The icon  flashes and a sound signal alerts you
The blue indicator light flashes in the event of a cold circuit fault
The red indicator light flashes in the event of a hot circuit fault

The sound alarm cuts out if one of the buttons is pressed,  or  *

• However, the icon stays displayed until the problem is solved

In this case, please contact your EuroCave dealer

***For multi-temperature models, the buttons are located to the right of the casing.**

Warning: Any intervention on the cold circuit must be carried out by a qualified expert who should carry out a circuit sealing check before starting it up again.

In the same way, any intervention on the electrical circuit should be carried out by a qualified electrician.

III- Temperature probes

In the event of a failure in the temperature measurement probes, the 2 displays shown opposite will light up and flash in turn. The displays stay lit until the problem is solved
In this case, please contact your EuroCave dealer.

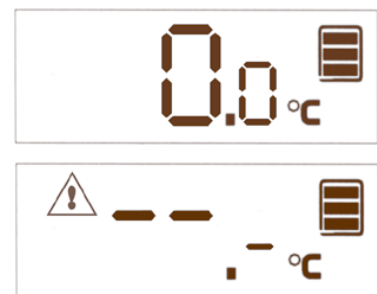

IV- Frost prevention device

Your cabinet is equipped with a frost prevention device to protect you in the event of a cold circuit failure (see above chapter)

V- Lighting

In the event of a lighting failure, do not handle the casing or the diodes. Contact your dealer.

NB: In all cases, if you feel your appliance is not behaving normally, contact your dealer.



11 - TECHNICAL SPECIFICATIONS

	Size (mm)			Unloaded weight (kg)	Usage limits	
	H	W	D (without handle)		Min. T° (C° / F°)	Max. T° (C° / F°)
I temperature						
V 059	820	594	552	43	0	35/32
V 159	1220	594	552	48	0	35/32
V 259	1780	594	552	61	0	35/32
Multi-temperatures						
S 059	820	594	552	43	12/54	35/32
S 159	1220	594	552	48	12/54	35/32
S 259	1780	594	552	61	12/54	35/32

Setting precision: +/- 1°C (2°F)- Display precision +/- 0.5 °C (1°F).

I 2 - SIMULATIONS DE RANGEMENT

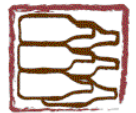

I 2 - STORAGE LAYOUT EXAMPLES

I 2 - LAGERUNGS-BEISPIELE

I 2 - SIMULACIONES DE COLOCACIÓN



12 - I TEMP. V059 / MULTI-TEMP. S059

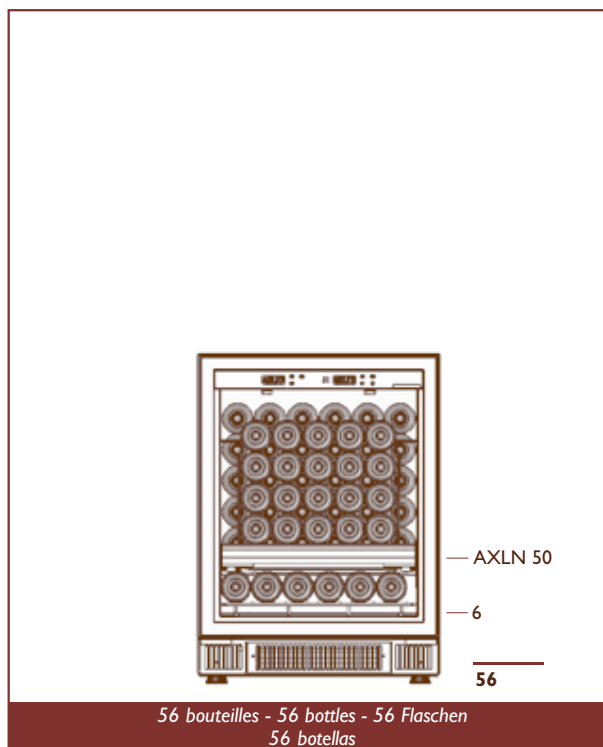

V/S - Stockage - Storage - Lagerregal - Almacenamiento

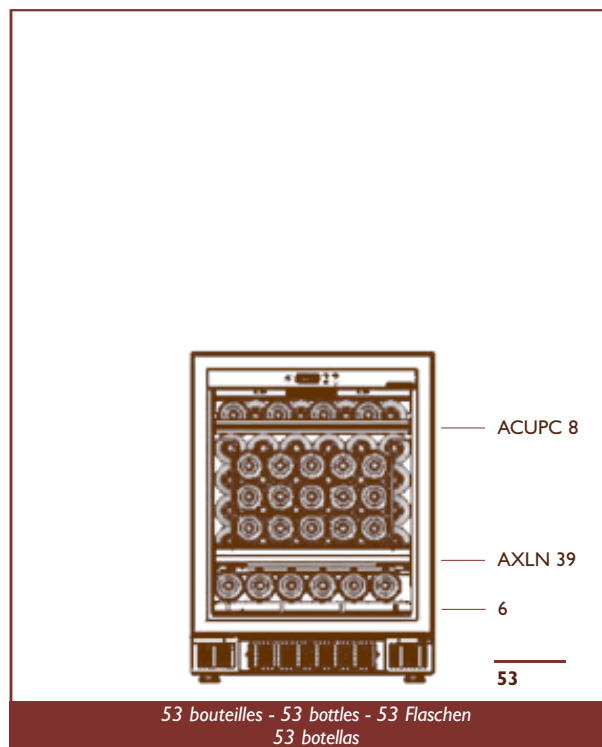

V/S - Mixte - Mixed - Gemischte Regalsysteme - Mixta

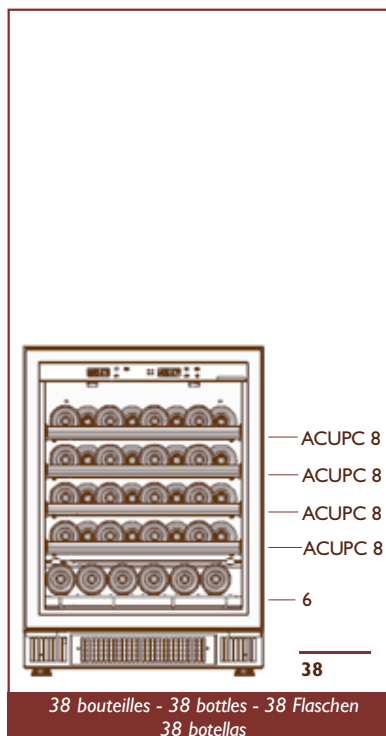

V/S - Coulissante - Sliding - Auszugsregale - Deslizante

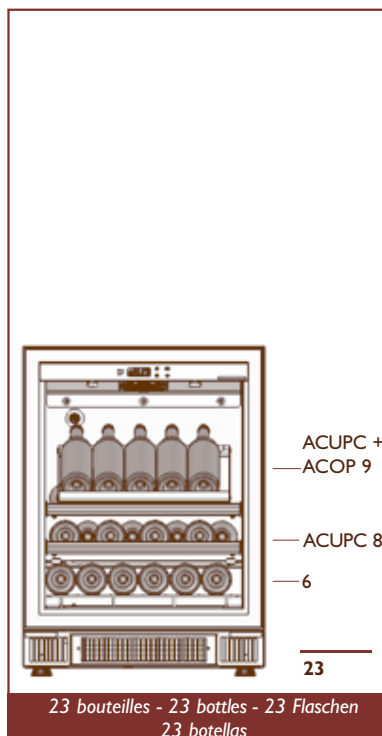

V - Présentation - Presentation - Präsentationsregale - Presentación

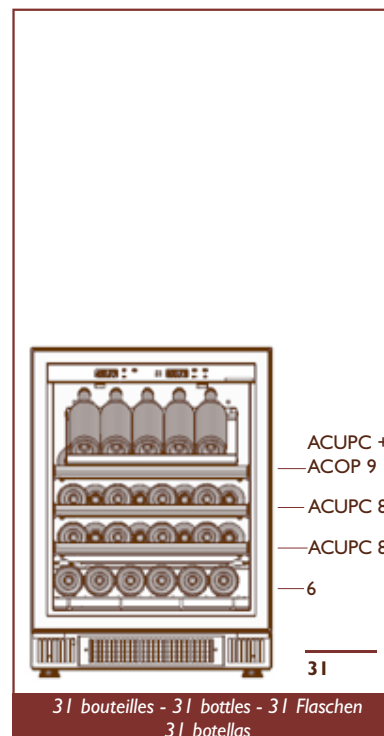

S - Présentation - Presentation - Präsentationsregale - Presentación

*Les capacités des armoires sont calculées en configurations usine, avec des bouteilles Bordeaux Tradition.

*The cabinet capacities are calculated in factory configuration using traditional Bordeaux bottles.

*Die Kapazitäten der Schränke werden mit Bordeauxflaschen „Tradition“ in Fabrik-Konfigurationen berechnet.

*Las capacidades de las bodegas están calculadas en configuraciones de fábrica, con botellas Burdeos Tradición.

12 - 1 TEMP. V159 / MULTI-TEMP. S159

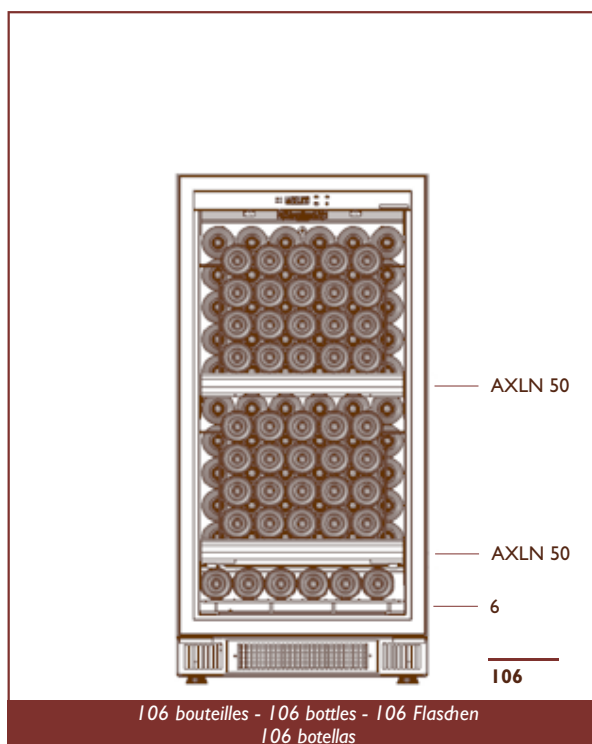
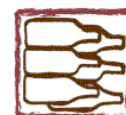

V/S - Stockage - Storage - Lagerregal - Almacenamiento

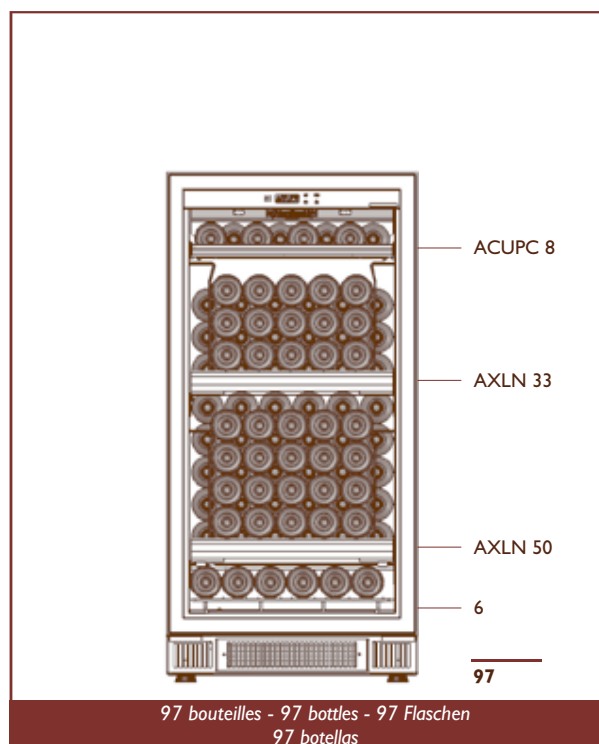

V/S - Mixte - Mixed - Gemischte Regalsysteme - Mixta

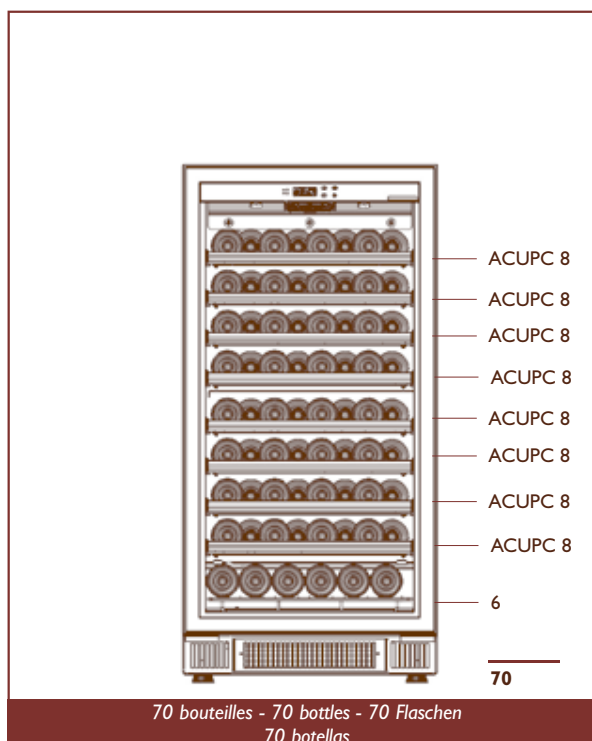

V/S - Coulissante - Sliding - Auszugsregale - Deslizante

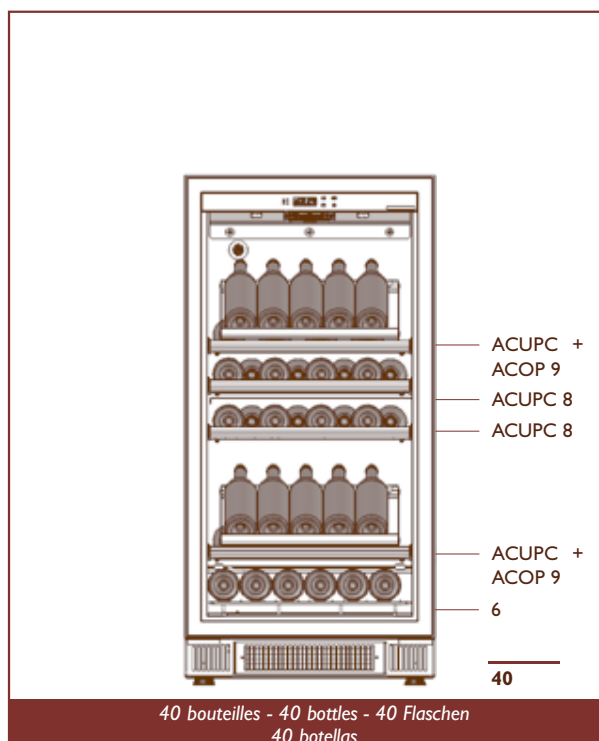

V/S - Présentation - Presentation -
Präsentationsregale - Presentación

*Les capacités des armoires sont calculées en configurations usine, avec des bouteilles Bordeaux Tradition.

*The cabinet capacities are calculated in factory configuration using traditional Bordeaux bottles.

*Die Kapazitäten der Schränke werden mit Bordeauxflaschen „Tradition“ in Fabrik-Konfigurationen berechnet.

*Las capacidades de las bodegas están calculadas en configuraciones de fábrica, con botellas Burdeos Tradición.



12 - I TEMP.V 259 / MULTI-TEMP. S 259

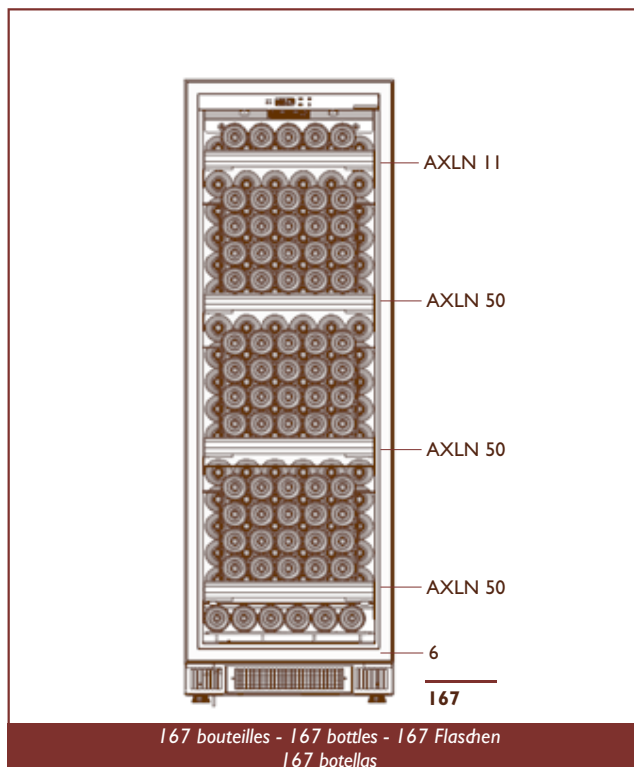

V/S - Stockage - Storage - Lagerregal - Almacenamiento

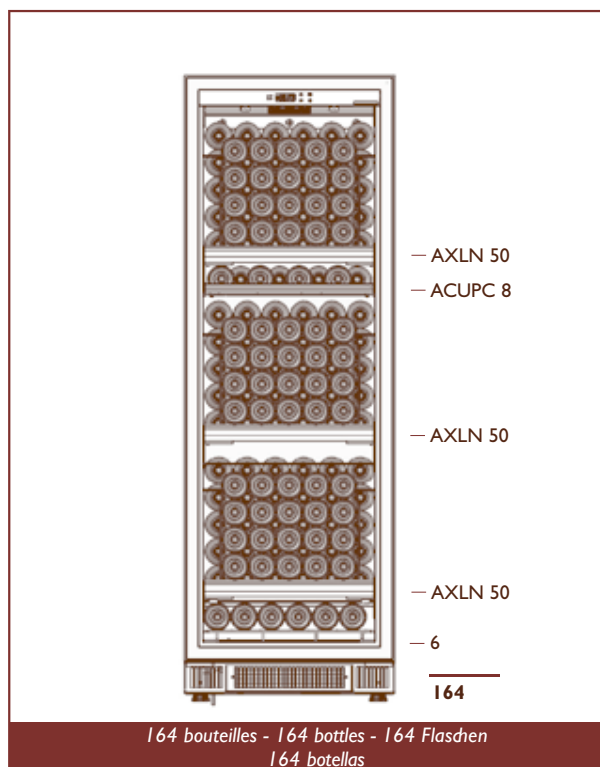

V/S - Mixte - Mixed - Gemischte Regalsysteme - Mixta

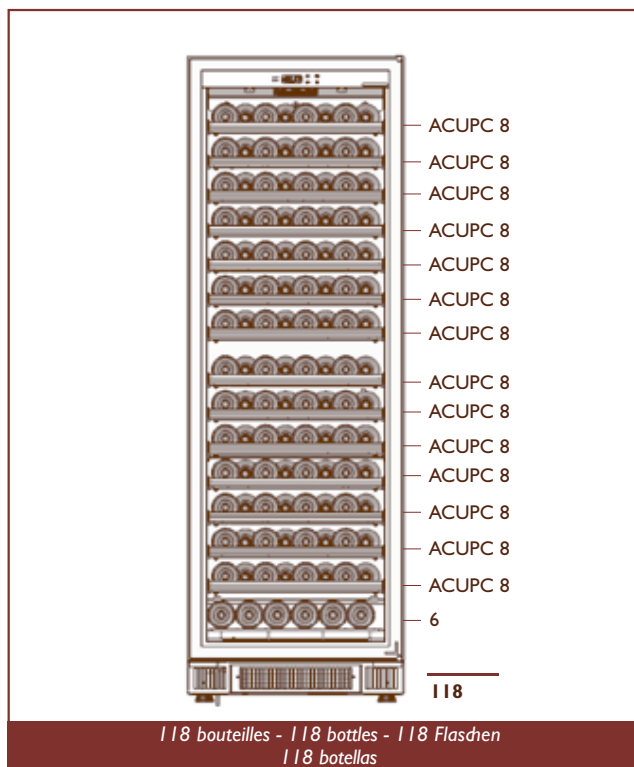

V/S - Coulissante - Sliding - Auszugsregale - Deslizante

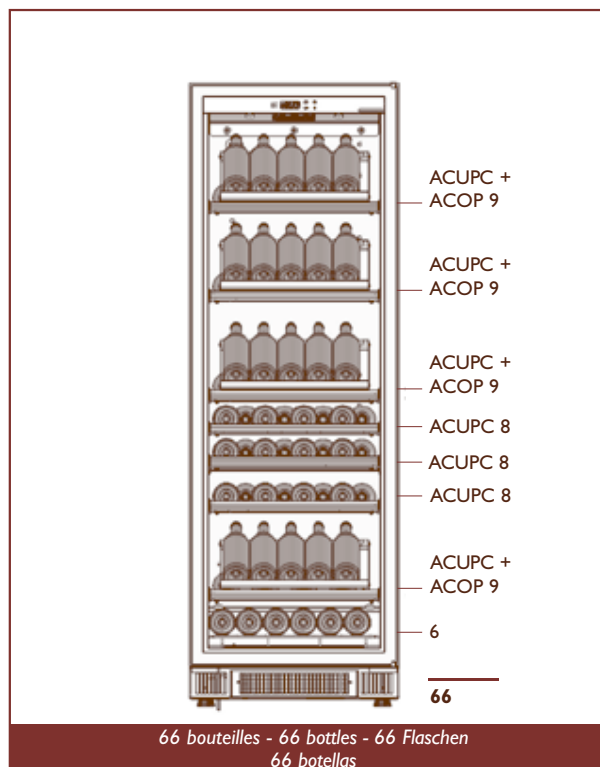

V/S - Présentation - Presentation - Präsentationsregale - Presentación

*Les capacités des armoires sont calculées en configurations usine, avec des bouteilles Bordeaux Tradition.

*The cabinet capacities are calculated in factory configuration using traditional Bordeaux bottles.

*Die Kapazitäten der Schränke werden mit Bordeauxflaschen „Tradition“ in Fabrik-Konfigurationen berechnet.

*Las capacidades de las bodegas están calculadas en configuraciones de fábrica, con botellas Burdeos Tradición.

AVERTISSEMENT

Les informations contenues dans ce document sont sujettes à modifications sans préavis.

EuroCave n'offre aucune garantie sur cet appareil lorsqu'il est utilisé pour un usage particulier autre que celui pour lequel il a été prévu. EuroCave ne pourra pas être tenu pour responsable des erreurs contenues dans le présent manuel, ni de tout dommage lié ou consécutif à la fourniture, la performance ou l'utilisation de cet appareil.

La photocopie, la reproduction ou la traduction totale ou partielle de ce document sont formellement interdites, sans le consentement préalable et écrit de EuroCave.

WARNING

The information in this document is subject to modification without prior notice.

EuroCave offers no guarantee on this equipment item if it is used for any specific purpose other than that for which it was designed. EuroCave cannot be held responsible for any errors in this manual, nor for any damage linked to or following the provision, performance or use of the equipment item.

All photocopying, reproduction, translation, whether partial or total, are strictly prohibited, without prior written consent from EuroCave.

WARNUNG

Die Angaben in diesem Dokument können ohne Ankündigung geändert werden.

EuroCave gewährt keine Garantie, wenn das Gerät anders als für seine gedachte Zweckbestimmung eingesetzt wird. EuroCave haftet nicht für Fehler, die diese Anweisung enthalten könnte und auch nicht für Schäden in Zusammenhang oder im Anschluss an die Lieferung, Leistung oder Verwendung des Gerätes. Das Dokument darf ohne zuvoriges und schriftliches Einverständnis von EuroCave weder ganz noch teilweise fotokopiert, vervielfältigt oder in andere Sprachen übersetzt werden.

ADVERTENCIA

Las informaciones contenidas en este documento están sujetas a modificaciones sin previo aviso.

EuroCave ofrece ninguna garantía sobre este aparato cuando se utilice para un uso particular distinto de aquel para el que ha sido previsto. EuroCave no podrá ser considerado responsable de los errores contenidos en el presente manual, ni de cualquier daño asociado o consecuente al suministro, las cualidades técnicas o la utilización de este aparato.

La fotocopia, la reproducción o la traducción total o parcial de este documento están formalmente prohibidas, sin el consentimiento previo y por escrito de EuroCave.



EuroCave®

Leader dans le domaine de la conservation, la présentation et le service des vins depuis plus de 30 ans, EuroCave vous propose des solutions adaptées à chacun de vos besoins. Armoires à vins, rangements, climatiseurs de cave, système de Vin au Verre....n'hésitez pas à contacter votre revendeur EuroCave pour toute information complémentaire !

Leader in the wine preservation, presentation and service sector for over 30 years, EuroCave offers you solutions adapted to every one of your requirements. Wine cabinets, storage layouts, cellar conditioners, wine by-the-glass system... don't hesitate to contact your EuroCave dealer for further information!

Seit mehr als 30 Jahren führend im Bereich der Lagerung, der Präsentation und dem Ausschank von Weinen schlägt Ihnen EuroCave Lösungen vor, die jedem Ihrer Bedürfnisse angepasst sind: Wein-, Zigarrenklimaschränke, Weinkeller-Kompaktklimaanlagen, Geräte für den glasweisen Offenausschank, Weinkeller-Regalsysteme
Zögern Sie nicht länger, setzen Sie sich mit Ihren EuroCave-Händler in Verbindung, wenn Sie noch irgendwelche Fragen haben!

Líder en el campo de la conservación, presentación y el servicio de vinos desde hace 30 años, EuroCave le propone soluciones adaptadas a cada una de sus necesidades. Bodegas, estanterías, climatizadores de bodegas, sistemas de vinos a la copa... ¡Para toda información complementaria, no dude en contactar a su distribuidor EuroCave!

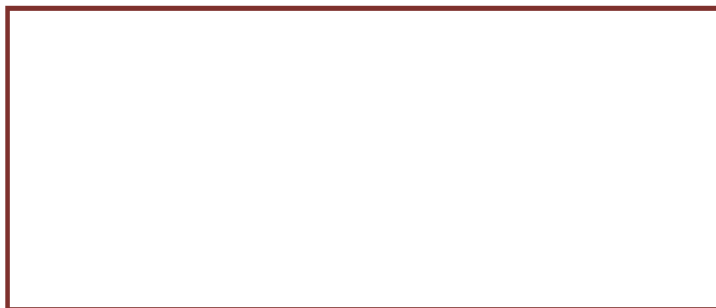

www.eurocave.com - info@eurocave.com

11/2005-1500 - 8200417