

CONTENTS



1 • DESCRIPTION OF YOUR WINE CABINET

- A. Free-standing range (Models 5083 V or S - 5283 V or S) p.2
- B. Free-standing range (Model 5290 only) p.3
- C. Flush-fitting range (Models 5059 V or S - 5259 V or S) p.4



2 • IMPORTANT SAFETY RECOMMENDATIONS

p.5



3 • POWER SUPPLY

p.5



4 • CARING FOR THE ENVIRONMENT AND ENERGY SAVING

p.5



5 • INSTALLING YOUR WINE CABINET

p.6-9



6 • LAYOUT - STORAGE

p.10-12

- A. Free-fitting range (5083 / 5283 / 5290)
- B. Flush-fitting range (5059 / 5259)



7 • COMMISSIONING YOUR WINE CABINET

p.12-15

- I. Connection
- II. I-temperature model (5083V - 5283V - 5059V - 5259V)
 - A. Description
 - B. Setting the temperature
- III. Two-temperature model 5290
 - A. Description
 - B. Setting the temperature
- IV. Multi-temperature model (5083S - 5283S - 5059S - 5259S)
 - A. Description
 - B. Setting the temperature



8 • EVERYDAY MAINTENANCE

p.16



9 • OPERATING FAULTS

p. 16



10 • TECHNICAL FEATURES

p. 17



11 • STANDARD WINE SERVING TEMPERATURES

p. 18



12 • STORAGE SIMULATIONS

p. 111-113



I - DESCRIPTION OF YOUR WINE CABINET

A - Free-standing range (5083-V/S - 5283-V/S)

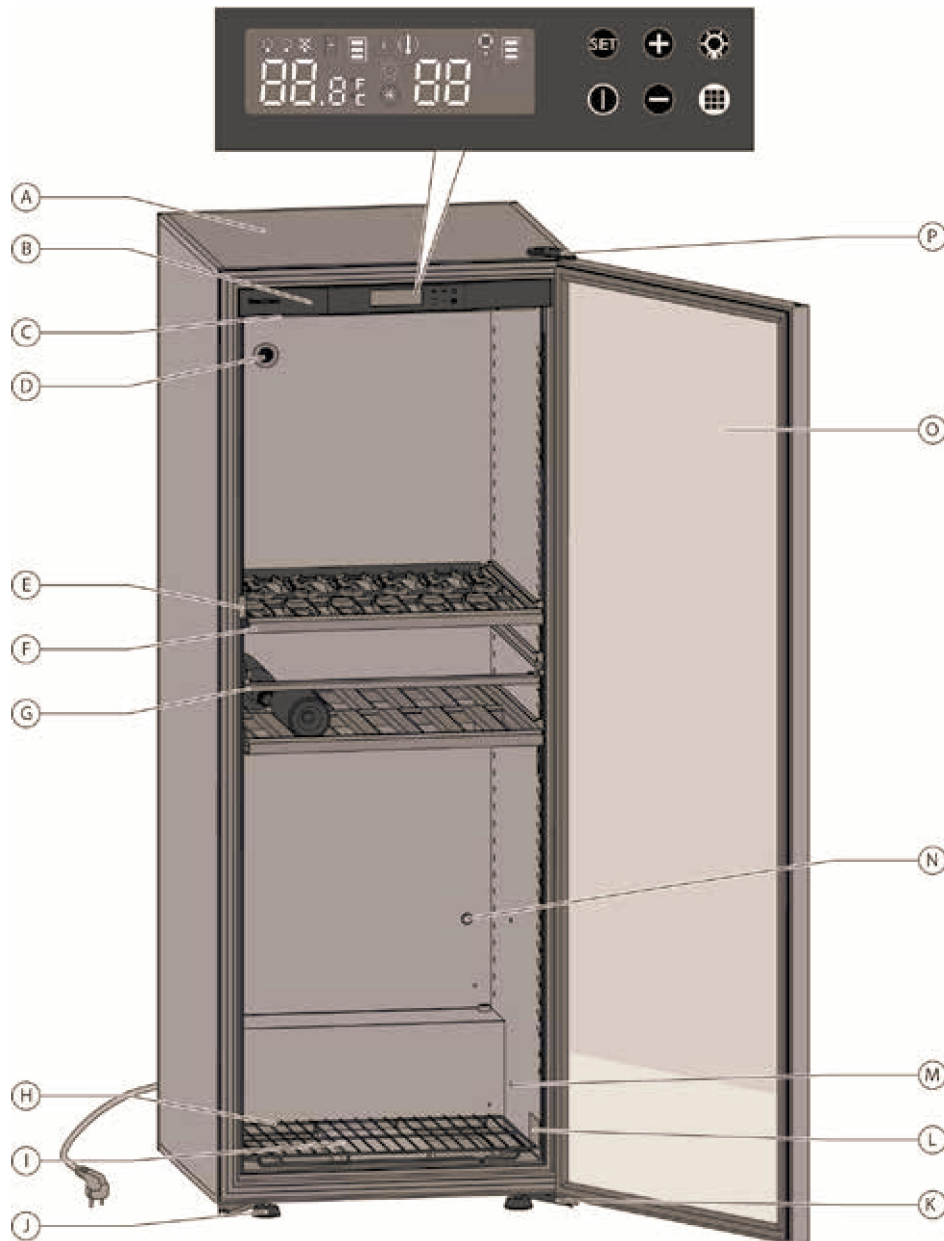

- A** Cabinet body
- B** Control panel
- C** Lighting (2 LEDs)
- D** Breather hole + active charcoal filter
- E** Door catch
- F** Sliding shelf
- G** Cabinet body stiffener (do not remove)
- H** Grill
- I** Humidity cartridge (I-temperature models)
- J** 2 adjustable feet for levelling

- K** Lower hinge
- L** Identification label
- M** Location of the sensors for two and multi-temperature cabinets
- N** Fresh air vent
- O** Door (fitted with a stainless steel handle and a dual action lock)
- P** Upper hinge

I - DESCRIPTION OF YOUR WINE CABINET



B - Free-standing range (5290 only)

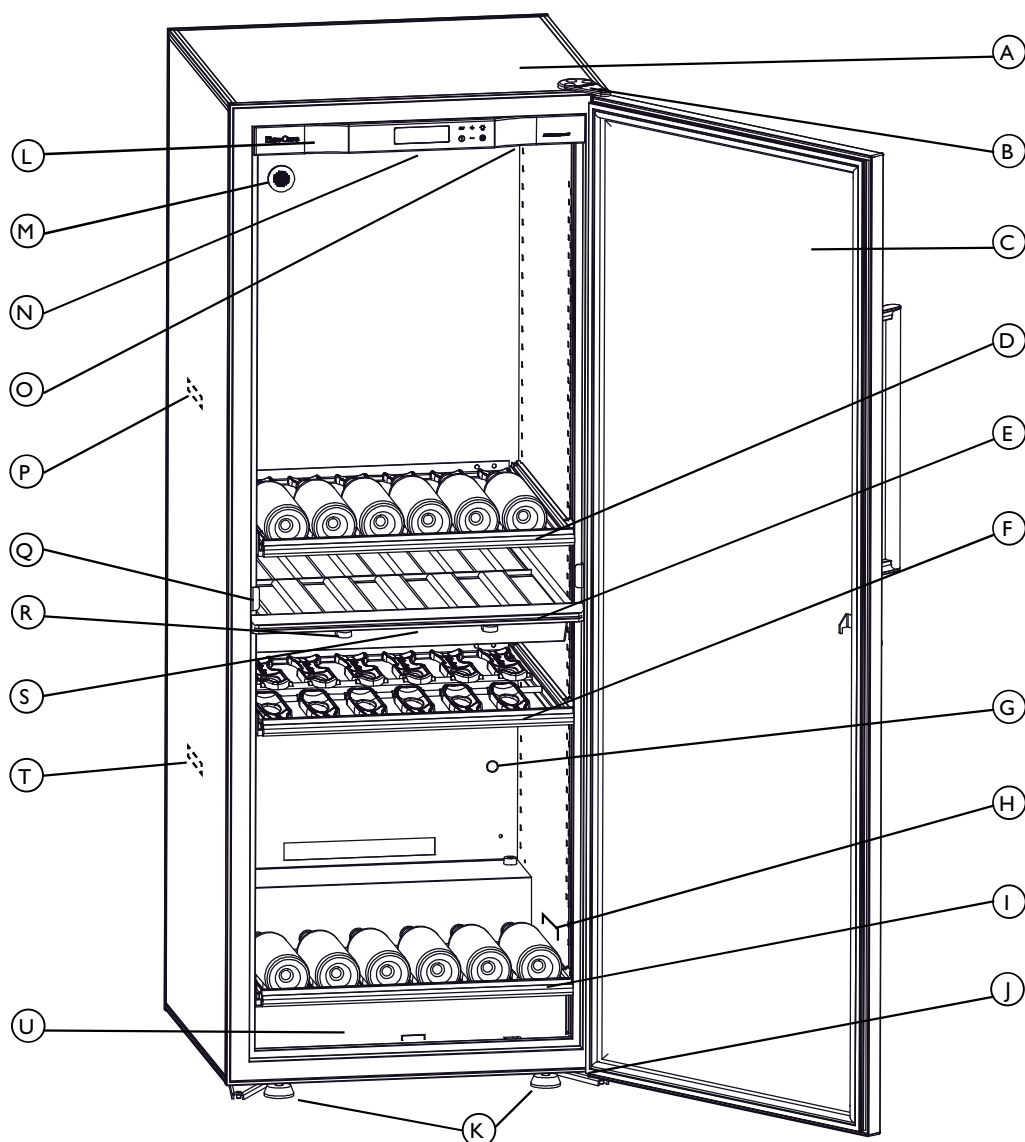

- A** Cabinet body
- B** Hinge
- C** Door (fitted with a handle and dual action lock)
- D** Sliding shelf
- E** Shelf separating the 2 compartments (includes the stiffener)
- F** Main Du Sommelier support
- G** Fresh air vent
- H** Identification label
- I** 6 bottle sliding shelf

- J** Door pin
- K** 2 adjustable feet for levelling
- L** Control panel
- M** Breather hole + active charcoal filter
- N** Upper fan
- O** Lighting (2 LEDs per compartment)
- P** Location of the temperature sensors
- Q** Lower fan
- R** Door catch
- S** Evaporator



I - DESCRIPTION OF YOUR WINE CABINET

C - Flush-fitting range (5059-V/S - 5259-V/S)

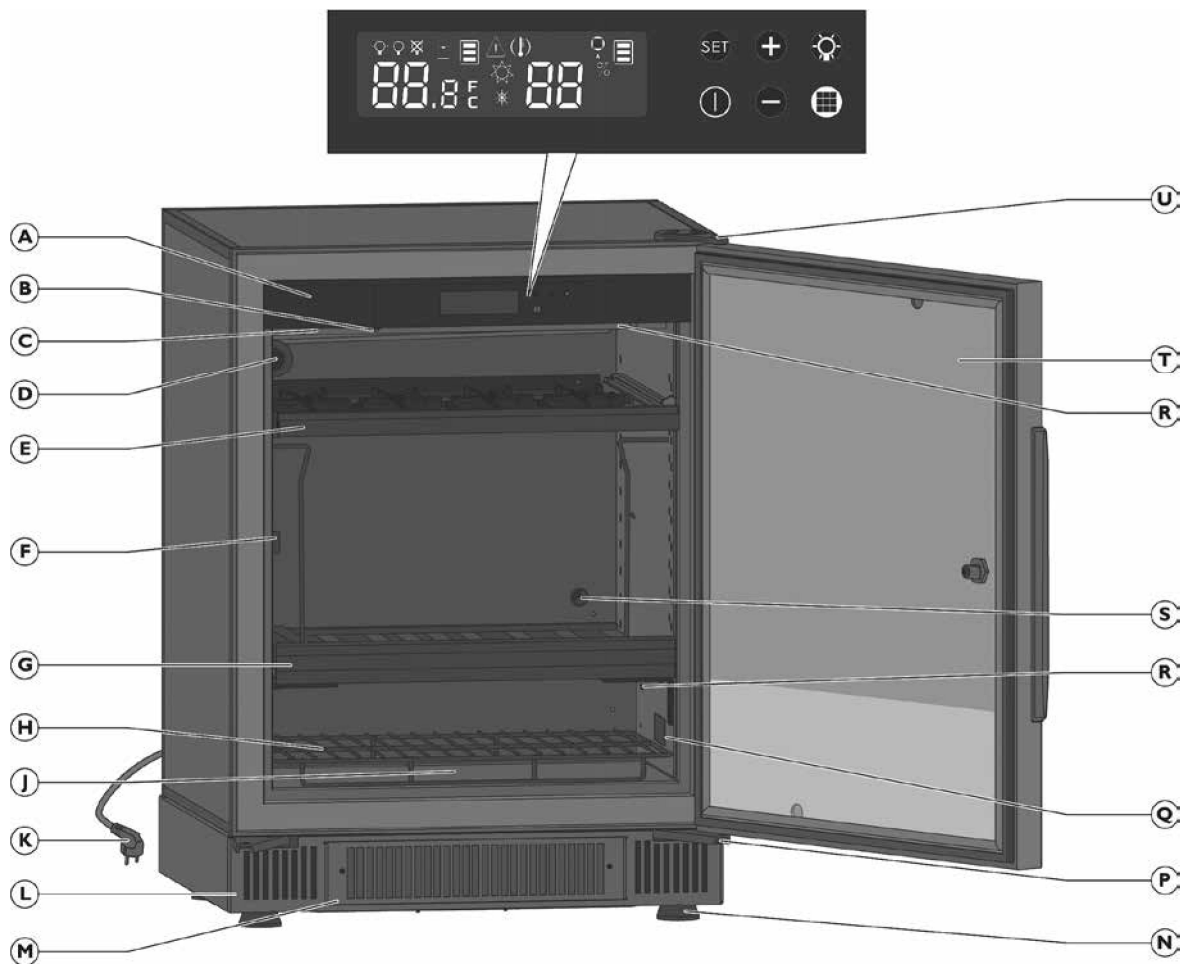

- A** Control panel
- B** Lighting (2 LEDs)
- C** Location of the sensor for I-temperature cabinets
- D** Breather hole + active charcoal filter
- E** Sliding shelf
- F** Door catch
- G** Storage shelf
- H** Grill
- J** Humidity cartridge (I-temperature models)
- K** Power cable
- L** Base with front vent

- M** Grid for accessing the filter and ventilation filter
- N** 4 feet, adjustable in height
- P** Lower hinge (x2)
- Q** Identification label
- R** Location of the sensor for multi-temperature cabinets
- S** Fresh air vent
- T** Door (fitted with a stainless steel handle and dual action lock)
- U** Upper hinge

2 - IMPORTANT SAFETY RECOMMENDATIONS



Read these operating instructions carefully before using your appliance for the first time and retain them for future use. Using your appliance in a way that contravenes these operating instructions may damage it.

- This appliance is only intended for storing wine. Only use the appliance for the purpose for which it was designed, as described in these operating instructions.
- Unplug your appliance if not using for a long time and before carrying out any cleaning or maintenance work. Unplug your appliance by pulling the plug, not the power cable. Never use a damaged power cable or one with signs of wear along its length.
- Only use the power cable supplied with the appliance and only plug into an earthed wall socket. Your appliance must only be used indoors (see table of ambient operating temperatures, p. 19). If the power cable, plug or appliance appear to be damaged or are not working correctly, contact your EuroCave retailer. Do not place the appliance, power cable or plug in water or any other liquid.
- Do not leave the power cable within reach of children or let it hang over a square corner or close to a source of heat.

- Do not place the appliance on a hot surface such as a hotplate and do not use it close to a source of heat (radiator, naked flame, window...).
- Place the appliance on a flat, stable, non-flammable surface, a suitable distance away from sinks or taps, to prevent water or other liquids splashing onto it.
- This appliance was not designed to be used by people (including children) with reduced mental, sensory or physical abilities or people lacking experience or knowledge unless somebody responsible for their safety supervises them or has given them prior instructions on how to use the appliance. Children should be supervised to ensure that they do not play with the appliance.

3 - POWER SUPPLY



i For your personal safety, the wine cabinet must be correctly earthed. Ensure that the socket is correctly earthed and that your installation is protected by a circuit breaker (30 mA*)
*Not applicable to some countries

The wine cabinet's power cable has a plug, to be plugged into an earthed standard outlet to prevent any risk of electric shock.



Have the power supply socket checked by a qualified electrician who will tell you whether or not it is correctly earthed and will carry out, if necessary, work to bring it into compliance with current standards.

Contact your usual EuroCave retailer to change the power cable if it is damaged. It must be replaced by a EuroCave original manufacturer's part.



If you are moving to a foreign country, check whether or not the supply characteristics of the cabinet correspond to the country (voltage, frequency).

4 - CARING FOR THE ENVIRONMENT AND ENERGY SAVING



Disposing of packaging



The packaging used by EuroCave is manufactured in recyclable materials. After unpacking your cabinet, take the packaging to a refuse collection point. For the most part, it will be recycled.

Recycling: a caring gesture

Electrical and electronic equipment has potentially harmful effects on the environment and human health owing to the presence of dangerous substances.

Therefore, you should never trash electrical and electronic equipment with unsorted municipal waste. When purchasing a new EuroCave product, you can entrust recycling of your old appliance to your EuroCave retailer. Talk to your EuroCave retailer, he will explain to you the removal and

collection procedures set up within the EuroCave network. In compliance with legislation concerning protecting and caring for the environment, your wine cabinet does not contain C.F.C.s.

To save energy

- Install your wine cabinet in a suitable place (see next page) and observe the recommended temperature setting ranges.
- Keep the door open for as short a time as possible.
- Check that the door seal is in good condition and that it is not damaged. If it is, contact your EuroCave retailer.

Disable unusable appliances by unplugging them and removing the power cable.



5 - INSTALLING YOUR WINE CABINET

Unpacking

- When delivered, check the outside of your cabinet for signs of damage (impact, buckling...).
- Open the door and check that the inside of your appliance is intact (walls, Main du Sommelier supports, hinges, bottle shelf...).
- Remove the protective elements inside your cabinet.

If there is a problem, contact your EuroCave retailer.



When moving the cabinet, do not tilt it more than 45° and always on its side, on the side of the power cable.

Precautions

- Do not place your cabinet in an area liable to flood.
- Do not place your cabinet close to a source of heat or in a location where it will be subject to direct sunlight.
- Prevent water from splashing on any part of the rear of the appliance.
- Position your appliance so that there is a minimum gap of 5 – 10 cm between the wall and the rear wall of your cabinet.
- If installing under a work surface, leave a minimum gap of 5 cm all around the appliance, including underneath the work surface. Provide an air vent on the work surface (recommended).
- Arrange the power cable so that it is accessible and does not come into contact with any of the appliance's components.
- Slightly tilt the cabinet backwards in order to adjust the front feet (adjust them by screwing or unscrewing), in order to level your cabinet (use of a spirit level recommended).

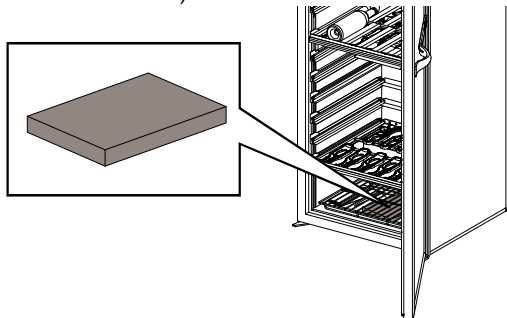

- Take the power cable (located in your cabinet's "accessories" box) and plug it into the connector, located on the bottom left-hand side of the rear of the cabinet (see diagram below).

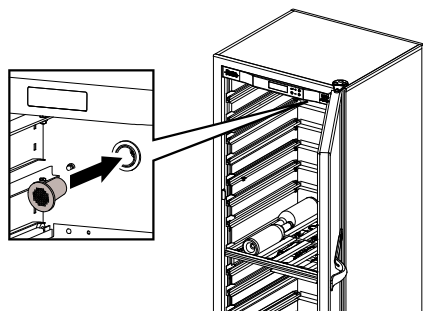

Installation

Transport your cabinet to its intended location.

It must:

- be open to the outside to allow circulation of air (not enclosed in a cupboard...),
- not be too damp (laundry room, utility room, bathroom...),
- have a flat, stable floor,
- be supplied with power (standard outlet, 16 A, earthed with circuit breaker, 30 mA* (* not applicable to some countries)).

- Take the charcoal filter from the "accessories" box and insert (via the inside of the cabinet) in the breather hole located on the top left-hand side (see diagram below).

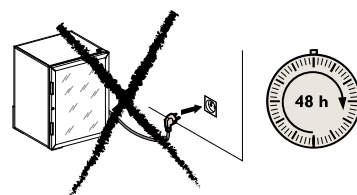
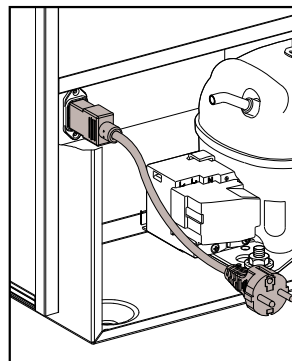

When using the appliance for the first time, the charcoal filter alarm will display. Reset the filter meter to 365 (see chapter 7, § VI).



N.B.: replacement of the LEDs on the control panel must only be carried out by a qualified electrician.

5 - INSTALLING YOUR WINE CABINET



Fastening a 5259 wine cabinet to the wall

For large models, if your wine cabinet is not flush-fitted, it is vital that it is fastened to the wall. If not, it could tip over.

You will find all the necessary parts in the accessories pack supplied with your appliance. To fit (see diagrams below):

- 1 Unscrew the screws **A**.
- 2 Fasten bracket **B** equipped with its nut **C** to the cabinet using the screws .
- 3 Position the wall bracke **D** on the nut **C** to determine the location of the drill holes of the wall securing screws.
- 4 Drill the holes then fasten the wall bracket **D** using the appropriate screws **E**



N.B.: provide a wall mounting sufficient for a pull force equal to 100 kg.

- 5 Fully tighten the screw **G** with the washer **F** until there is contact between the wall bracket **D** and the nut **C**.

Only fully tightening the screw guarantees correct fastening of all parts. Repeat the procedure for the other side of the cabinet.

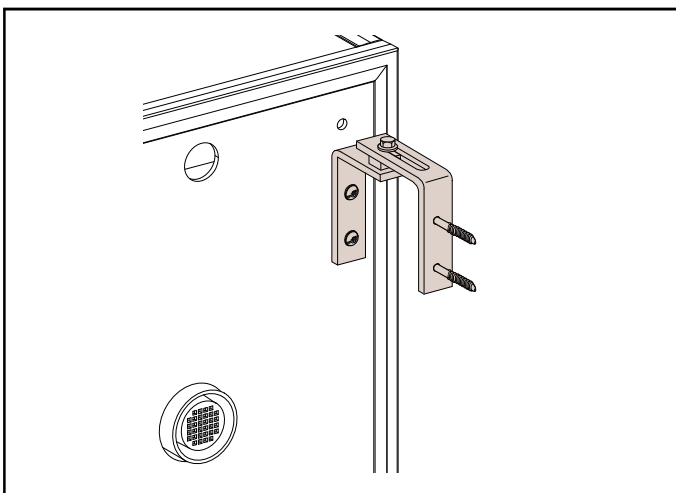
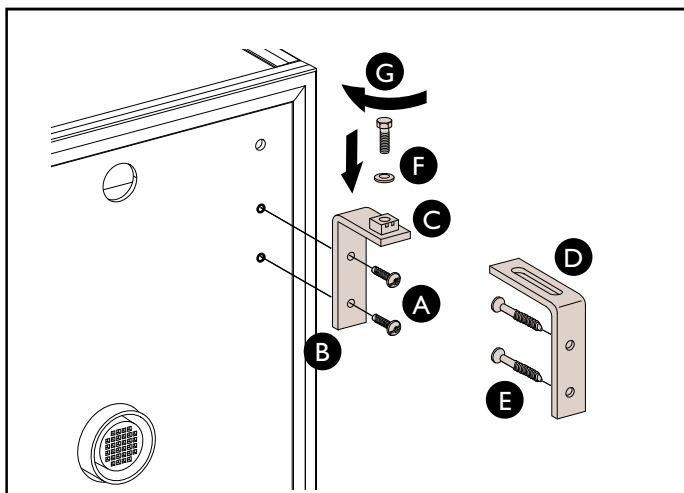



5 - INSTALLING YOUR WINE CABINET

I. Flush-fitting

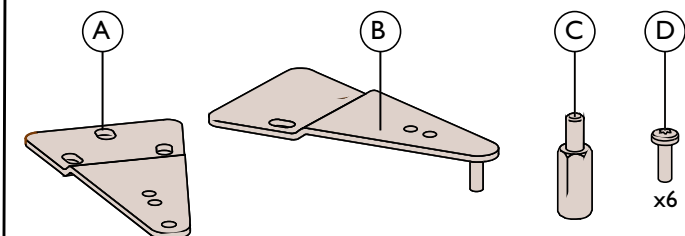

- A** Hinge without pin
- B** Flush-fitting hinge
- C** Raising piece (5059 model only)
- D** 25 Torx screw

Dimensions to observe for a glass or full glass door:

	A max	A min	B	C min
5059	832	816	Glass door	549
			Full glass	547,5
5259	1792	1776	Glass door	566
			Full glass	565

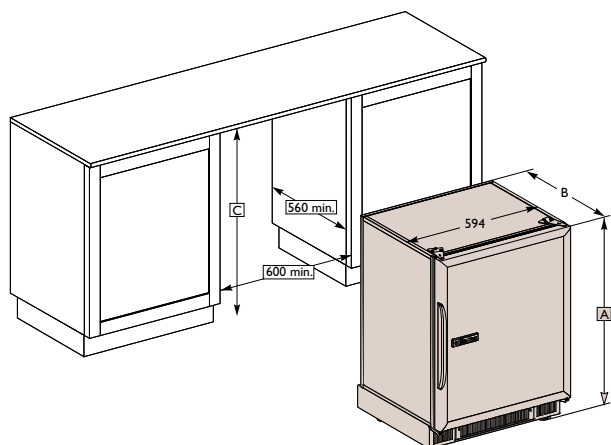

Changing the hinges

- 1** Unscrew the three screws using a "T25" Torx wrench.
- 2** Remove the upper hinge.
- 3** Carefully remove the caps using a thin blade.

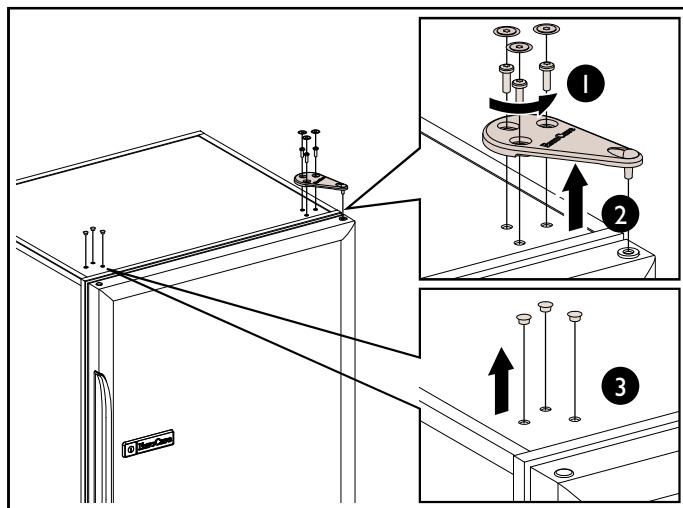

Precautions: When closing the door, check that the seal firmly adheres to the cabinet body to ensure effective air-tightness.

- Fit the hinge with pin **B** using the screws so that the door is completely parallel to the cabinet body.
- Fit the hinge without pin **A** using the screws.

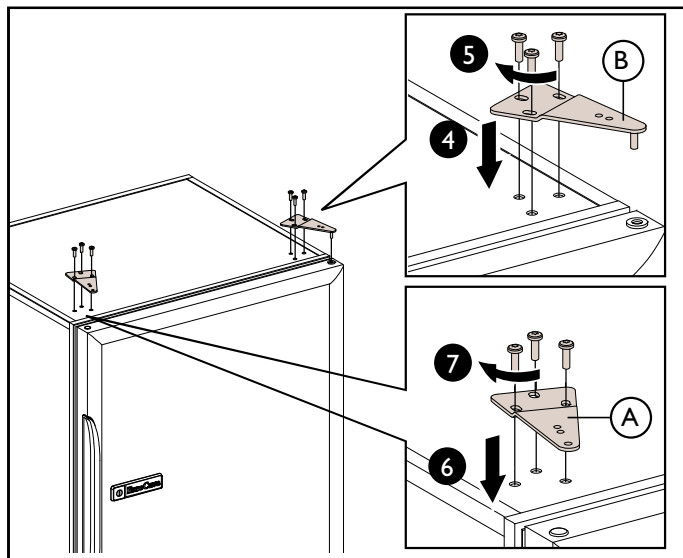

Precautions: if you remove the cabinet's glass door, never place it on its side as the glass could break.

5 - INSTALLING YOUR WINE CABINET



Fastening and adjusting the feet (to be carried out when the cabinet is empty)

- The wine cabinet's 4 feet can be adjusted in height in order to adapt to the height under the work surface or inside the unit and to allow you to ensure alignment of the door with adjacent units.

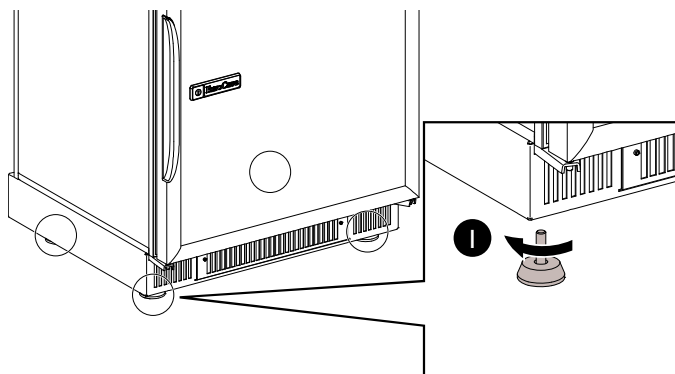

- If necessary, use the hexagonal raising pieces, which you will find in the "accessories" pack.
- Tilt the appliance forwards, making sure that you keep the door closed.
- Unscrew the back feet and fit the raising pieces using a 17 mm open-ended spanner.

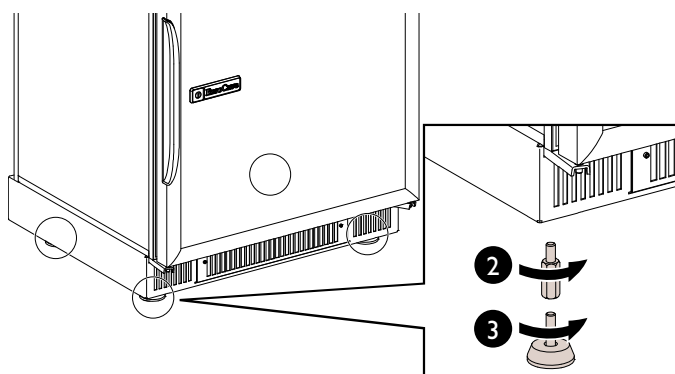

- Screw the 2 back feet onto the raising pieces.
 - Repeat these actions for the 2 front feet, making sure that you tilt the appliance backwards.
- Never obstruct the front air vent as this could affect the cabinet's performance.

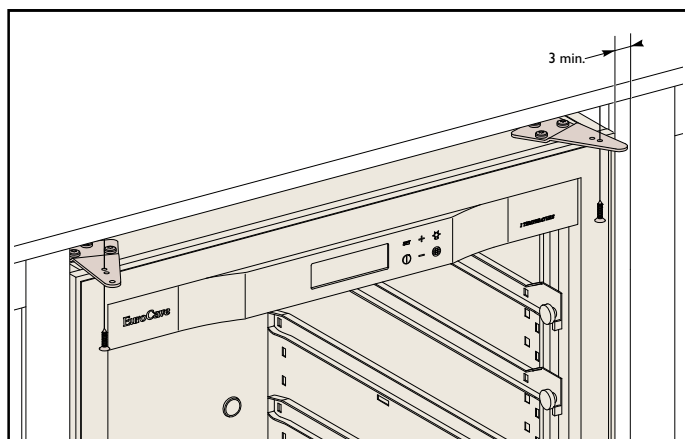

The plug must be accessible once your appliance has been installed.

For large and medium-sized models, it is vital that the cabinet is fastened to the unit. If not, it could tip over. Have your fitter do this or check with your fitter that your appliance is securely fastened to the unit and that the unit is securely fastened to the wall.

Fastening a unit door to a technical door

- Position the cabinet so that it is level under the work surface or in the unit.
- Open the cabinet door to 90°.
- Fasten the front side of the kitchen unit to the door of the cabinet (8 screws supplied).
- Check that the seal is air-tight.
- Installing a cabinet in the upper part of a unité.

Installation d'une armoire en hauteur dans un meuble



For safety reasons, we do not recommend fitting the wine cabinet at a height in a unit.

However, if you choose to do so, have a unit specially designed or check with a furniture specialist that the unit holding the appliance, as well as the surrounding units, can support the weight of the cabinet filled with full bottles, i.e. 200 kg. Have the specialist guarantee the stability of the cabinet when opening the door or pulling out shelves loaded with full bottles.

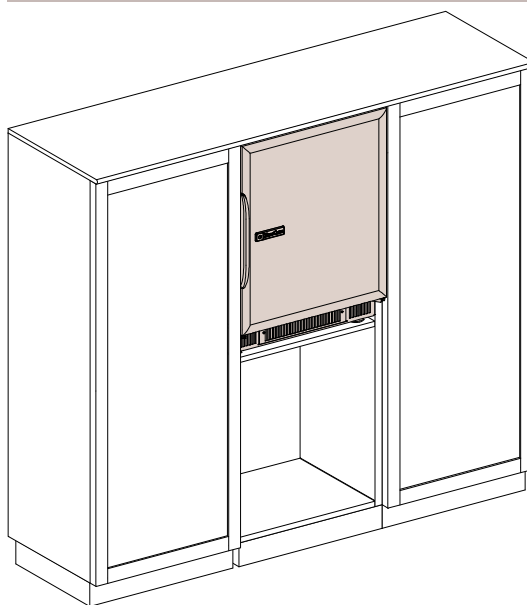

- Use suitable screws to fasten your wine cabinet under the work surface or in the unit via the holes in the hinges.

Précautions : on the side of the axis of rotation of the door, position the door a minimum of 3mm from the adjacent unit.



6 - LAYOUT - STORAGE

A - FREE-STANDING RANGE (5083 / 5283 / 5290)



Your EuroCave Professional wine cabinet was designed to be adaptable. In terms of storage capacity, it adapts to your needs: equipment can be changed or added to if your requirements change.

Different types of storage



Universal storage shelf
Réf. : AXUH

Capacity: 77 bottles
Max weight : 100 kg



Universal sliding shelf fitted with "Main du sommelier"
Réf. : ACMS

Capacity: 12 bottles



Magnum sliding shelf fitted with "Main du sommelier"
Réf. : ACGMS

Capacity: 7 bottles



Bordeaux storage shelf
Réf. : AXBH

Capacity: 78 bottles
Max weight : 100 kg



Sliding serving shelf
Réf. : ACVH

Capacity: 20 bottles



Articulated display kit for ACMS shelves
Réf. : AOPRESAR

Capacity: 32 bottles



Display shelf
Réf. : ACPH

Capacity: 22 bottles

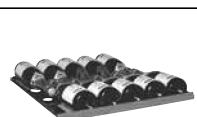

Champagne sliding shelf
Réf. : ACHH

Capacity: 10 bottles

aThe layout of your cabinet can be changed to suit your requirements. Refer to pages 111 - 113 to see storage simulations.

Advice concerning the layout of your wine cabinet

- Your EuroCave wine cabinet was designed to safely hold a maximum number of bottles. We recommend that you follow the advice below in order to optimize loading.
- Distribute your bottles as uniformly as possible over the various cabinet shelves, in order to spread the weight. Also make sure that your bottles do not touch the back wall of the cabinet.
- Ensure that you distribute your bottles uniformly (do not load the bottles all at the top or all at the bottom).
- Observe the loading instructions specific to your cabinet's type of storage equipment, and never stack bottles on a sliding shelf.

- If you have sliding shelves, it is preferable to position them in the upper part of your cabinet to facilitate daily access.

- **In the same way, position one or two bottles of each of your various wines on the sliding shelves and keep your spare bottles on the storage shelves. You then simply replace bottles when they are consumed. When using your wine cabinet, never pull out more than one sliding shelf at a time.**

Adding sliding shelves

When you purchase your cabinet, the sliding shelves are already adjusted to ideally suit the internal dimensions of your appliance. If you buy a new sliding shelf, you may need to carry out this adjustment. To do so, unscrew the screws ① of the first right or left runner ② (2 screws) then position the runner at the desired width and screw the screws. Repeat the procedure for the second runner (if necessary).



N.B.: Never change the position of the stiffener(s) in your cabinet (see description, page 5) without first consulting your retailer and never move this part when your cabinet is loaded.

6 - LAYOUT - STORAGEB - GAMME FLUSH-FITTING RANGE (5059 AND 5259)



Your EuroCave Professional wine cabinet was designed to be adaptable. In terms of storage capacity, it adapts to your needs: equipment can be changed or added to if your requirements change.

Different types of storage



Universal storage shelf
Réf. :AXLNH

Capacity: 50 bottles
Max weight: 85 kg



Universal sliding shelf fitted with "Main du sommelier"
Réf. :ACMSC

Capacity: 8 bottles



Optional extra: articulated display for ACMSC shelves
Réf. :AOPRES

Capacity: 9 bottles, 5 of which are inclined

The layout of your cabinet can be changed to suit your requirements. Refer to pages 111 - 113 to see storage simulations.

How to use your storage shelf (Ref.AXLNH)



To store **Bordeaux bottles** : swivel each metal rod so that it is in contact with the cabinet wall. Storage on 4 front rows and 5 back rows, i.e. 50 bottles*.

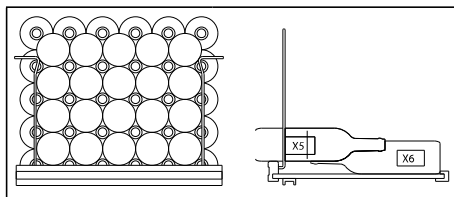

To store **Burgundy bottles** : remove the metal rods. Storage on 7 levels, 8 bottles per level, i.e. 56 bottles*.

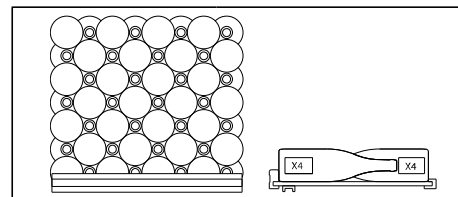

*For optimal performance, we recommend that you fill your cabinet to at least 75% of its capacity.

Advice concerning the layout of your wine cabinet

- Your EuroCave wine cabinet was designed to safely hold a maximum number of bottles. We recommend that you follow the advice below in order to optimize loading.
- Distribute the bottles as uniformly as possible over the various shelves in your cabinet in order to spread the weight. Also ensure that your bottles are not touching the back wall of the cabinet.
- Ensure that you distribute your bottles uniformly (do not load the bottles all at the top or all at the bottom).
- Observe the loading instructions specific to your cabinet's type of storage equipment and never stack bottles on a sliding shelf.
- If you have sliding shelves, it is preferable to position them in the upper part of your cabinet to facilitate daily access.

- In the same way, position one or two bottles of each of your various wines on the sliding shelves and keep your spare bottles on the storage shelves. You then simply replace bottles when they are consumed.
- When using your wine cabinet, never pull out more than one sliding shelf at a time.



N.B.: Never try to move or remove the stiffener in your cabinet when it is loaded (only for model 5259).

Adding sliding shelves

When you purchase your cabinet, the sliding shelves are already adjusted to ideally suit the internal dimensions of your appliance. If you purchase a new sliding shelf you may need to carry out this adjustment. To do so, unscrew the screws ① of the first right or left runner ② (2 screws) then position the runner at the desired width and tighten the screws. Repeat the procedure for the second runner (if necessary).

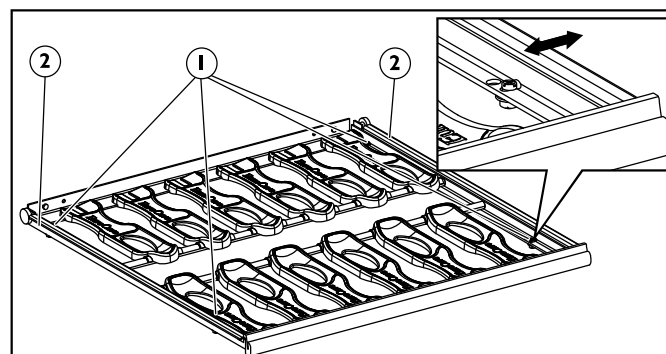



7 - COMMISSIONING YOUR WINE CABINET

I. Connecting



Have your socket checked (presence of correct sized fuse and 30 mA circuit breaker).
Do not plug several cabinets into an adaptor.

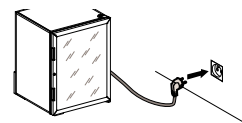

Check your type of wine cabinet

Press simultaneously the **+** and **-** keys.



Pour obtenir un fonctionnement optimal, nous vous conseillons de remplir votre cave au minimum à 75 % de sa capacité.

II - I-temperature model (5083V - 5283V - 5059V - 5259V)

A - Description :

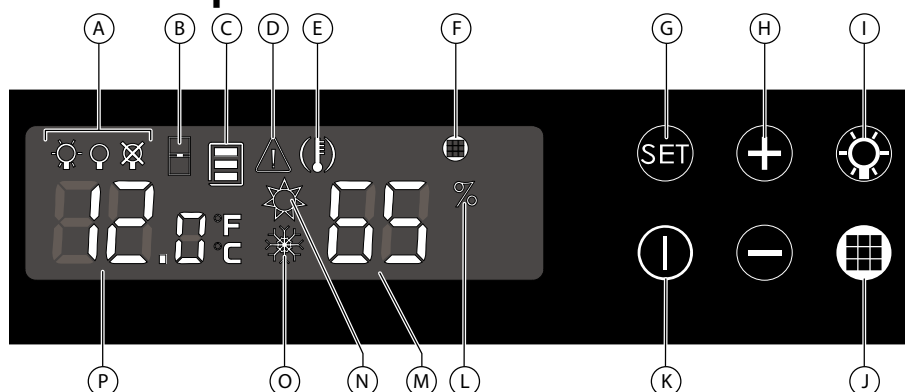

The tactile keys are very sensitive. There is no need to apply force, a light touch is sufficient to register the command. Remember to remove your finger from the panel between presses.

- A** Lighting mode
- B** Open door alarm
- C** Temperature zone
- D** Sensor fault alarm
- E** Temperature alarm
- F** Charcoal filter alarm
- G** Confirmation and access to settings key
- H** Setting and selection keys
- I** Lighting mode access and confirmation key
- J** Charcoal filter meter access
- K** Standby key
- L** Humidity level alarm
- M** Relative humidity level display
- N** Hot circuit indicator
- O** Cold circuit indicator
- P** Temperature display

B - Setting the temperature



- 1 Press and hold down the **SET** key for 5 secs to power up.
- 1 Press and hold down the **SET** key for approximately 5 secs. The display will start to flash.



- 2 Press the **+** or **-** keys to set the desired temperature.



- 3 Press the button **SET** to confirm.



The value shown on the display is the actual temperature of the cabinet. It is therefore necessary to wait before your new setting takes effect.

- The default setting is 12 °C (ideal wine maturing temperature). However, you can set the temperature between 5 - 20 °C.
- Recommended setting range for wine maturing: 10 - 14 °C.

N.B.: in order to operate correctly, your cabinet must be placed in a room with a temperature of 0 - 35 °C..



Turning your wine maturing cabinet into a wine serving cabinet: you can use your I-temperature cabinet as a wine serving cabinet to bring your white or red wines to the correct serving temperature (temperature setting range: 5 - 20 °C).

- For white wines: recommended temperature setting range: 6° - 10°C
- For red wines: recommended temperature setting range: 15° - 18°C

This cabinet can therefore also be used as a red or white wine serving cabinet.

7 - COMMISSIONING YOUR WINE CABINET



III - 2-temperature model 5290

A - Description :

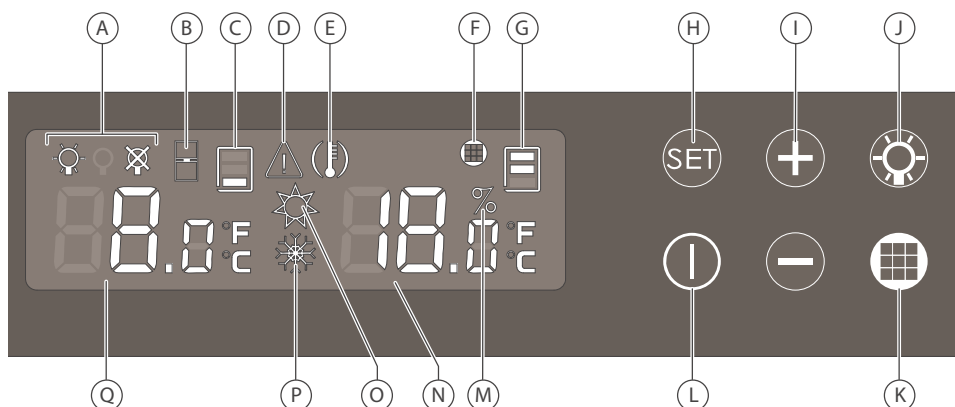

The tactile keys are very sensitive.

There is no need to apply force, a light touch is sufficient to register the command. Remember to remove your finger from the panel between presses.

- A** Lighting mode
- B** Open door alarm
- C** Chilling compartment temperature zone (lower compartment of the cabinet)
- D** Sensor fault alarm
- E** Temperature alarm
- F** Charcoal filter alarm
- G** Red serving temperature compartment temperature zone (upper compartment of the cabinet)
- H** Confirmation and setting access key
- I** Setting and selection keys
- J** Lighting mode access and confirmation key
- K** Charcoal filter meter access key
- L** Standby key
- M** Humidity level alarm
- N** Red serving temperature compartment temperature display
- O** Hot circuit indicator
- P** Cold circuit indicator
- Q** Chilling compartment temperature display

B - Setting the temperature

Chilling compartment temperature setting range: 6 - 12 °C.

Red serving temperature compartment temperature setting range: 16 - 20°C.



Appuyer 5 s sur la touche **I** pour la mise en route.

- 1** Press and hold down the **SET** key for approximately 5 secs.
The display will start to flash.

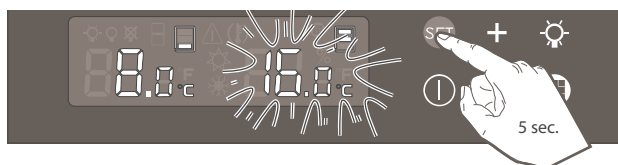

- 3** Press the **SET** button to confirm.
The temperature display of the serving temperature compartment will flash.



- 2** Press the **+** or **-** keys to set the desired temperature in the chilling compartment.



- 4** Press the **+** or **-** keys to set the desired temperature in the serving temperature compartment.
- 5** Press the **SET** button to confirm.

7 - COMMISSIONING YOUR WINE CABINET

IV. Multi-temperature model (5083S - 5283S - 5059S - 5259S)

A - Description:

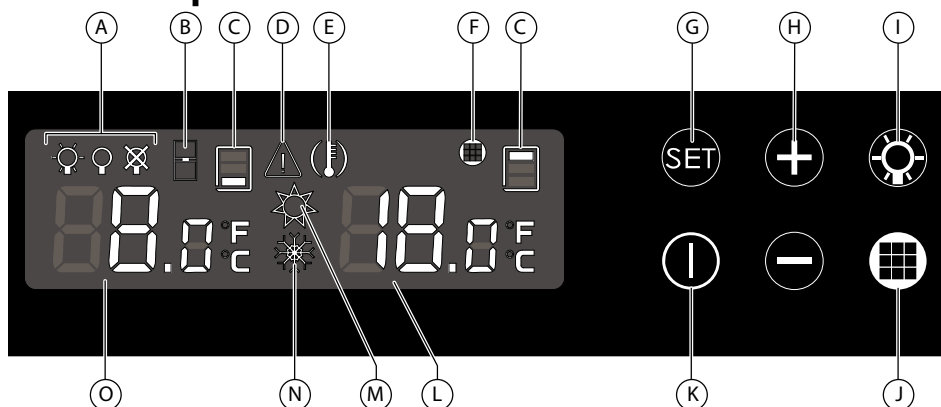

The tactile keys are very sensitive. There is no need to apply force, a light touch is sufficient to register the command. Remember to remove your finger from the panel between presses.

- A** Lighting mode
- B** Open door alarm
- C** Temperature zones concerned
- D** Sensor fault alarm
- E** Temperature alarm
- F** Charcoal filter alarm
- G** Confirmation and setting access key

- H** Setting and selection keys
- I** Lighting mode access and confirmation key
- J** Charcoal filter meter access key
- K** Standby key
- L** Highest temperature zone display
- M** Hot circuit indicator
- N** Cold circuit indicator
- O** Lowest temperature zone display

B - Setting the temperature

Recommended setting range for the lowest temperature zone: 7 - 9 °C.

Recommended setting range for the highest temperature zone: 17 - 20 °C.



In order for your multi-temperature cabinet to perform optimally, the upper and lower temperature settings must have a difference of 10°C (e.g.: 8°C at the bottom = 18°C at the top)



Press and hold down the key **I** for 5 secs to power up.

1 Press and hold down the key **SET** for approximately 5 secs. The display will start to flash.

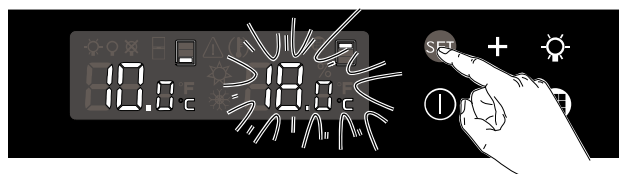

3 Press **SET** the button to confirm. The right-hand display will flash. to set the desired temperature.



The value shown on the display is the actual temperature inside the cabinet. It is therefore necessary to wait before your new setting takes effect.



2 Press the **+** or **-** keys **SET** to set the desired temperature



4 Press the **+** or **-** keys to set the desired level of relative humidity.

5 Press the button **SET** to confirm.

- For the lowest temperature zone, the default setting is 8 °C.
- However, this setting can be set between 5 and 12 °C.
- The default setting for the highest temperature zone is 18 °C.
- However, this setting can be set between 15 and 22 °C.

N.B.: in order to operate correctly, your cabinet must be placed in a room with a temperature of 12 - 35 °C.

7 - COMMISSIONING YOUR WINE CABINET



Your wine cabinet can measure humidity (only for 1 and 2-temperature models), allowing you to see the relative humidity level inside your appliance. The ideal humidity level is above 50%, ideally 60 - 75 %.



V. Setting the lighting mode



- 1 Press the key .
The indicator of the active mode will flash.

You have 3 setting options for lighting:

- Permanent lighting (mood lighting for a cabinet fitted with a glass door, for example).
- Lighting activated when the door opens (it is off when the cabinet door is closed).
- Lighting disabled.

If you want to increase the relative humidity level inside your cabinet, pour the equivalent of one glass of water into the channel of the tray located on the right-hand side of the bottom of the cabinet.

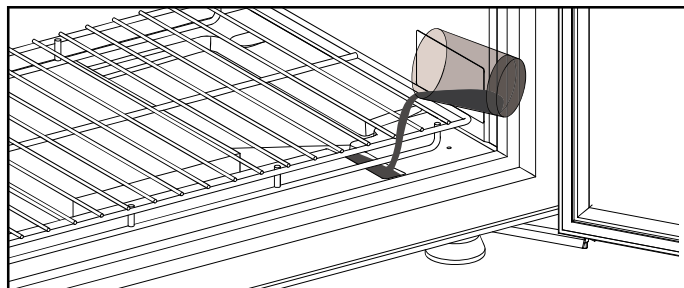

- 2 Press the or keys to select the desired mode.

- 3 Press the key to confirm.



Precautions to observe: bright light, never look directly at the beam.

VI. Charcoal filter meter display

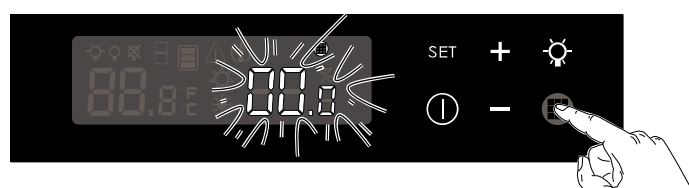

When commissioning or replacing the filter, set the meter to 365.

- 1 Press the key .
The display will flash.

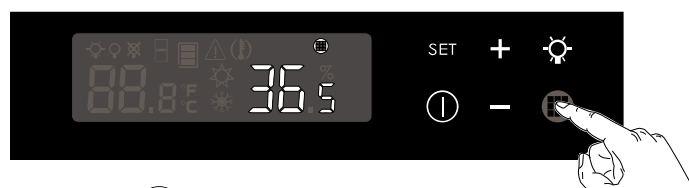

- 3 Press the to confirm.
The alarm display will turn off.



- 2 Press the key to set to 365.



The charcoal filter must be replaced every year.



You can consult the meter by pressing the key .



8 - EVERYDAY MAINTENANCE



Your EuroCave Professional wine cabinet is a tried and tested appliance.

Maintenance to be carried out approximately once a year

- Unplug and unload the appliance.
 - Remove dust from the condenser at the back of the appliance by vacuuming it.
 - Clean the inside of the compartments with water and a gentle cleaning product.
 - Rinse thoroughly.
 - Replace the active charcoal filter housed in the upper breather hole of your cabinet (see chapter S).
- Remove the charcoal filter manually. It is available from your usual retailer. It must be replaced by an original manufacturer's part.
- Check that the seals are in good condition.

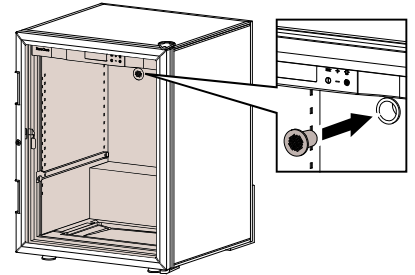

Regular monitoring of your cabinet and reporting any faults to your retailer will ensure that your appliance provides you with many years of faithful service.

Everyday maintenance only for the flush-fitting range (5059 / 5259)

Maintenance to be carried out approximately once a year

- Unplug and unload the appliance.
- Remove dust from the condenser at the back of the appliance by vacuuming it.
- Clean the inside of the compartments with water and a gentle cleaning product.
- Rinse thoroughly.
- Replace the active charcoal filter housed in the upper breather hole of your cabinet (see chapter S). Remove the charcoal filter manually. It is available from your usual retailer. It must be replaced by an original manufacturer's part.

Maintenance to be carried out every 3 months (only for the 5059 V/S model)

- Clean the ventilation filter:
- Remove the 2 screws from the grid using a n°2 hex head key (supplied in the accessories pack).
- Remove the grid, take the filter and hold it under running water.
- Leave it to dry then reassemble all the parts.
- Check that the seals are in good condition.

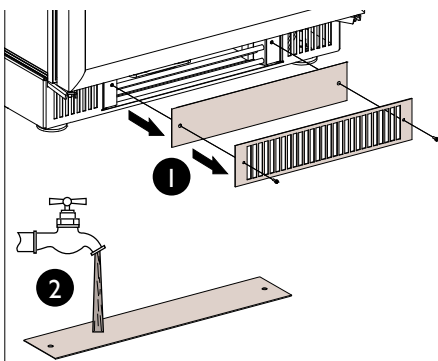







Regular monitoring of your cabinet and reporting any faults to your retailer will ensure that your appliance provides you with many years of faithful service.



Your appliance is fitted with a frost protection device, which provides protection in the event of a fault in the cold circuit control.

10 - OPERATING FAULTS



Incidents possibles	Causes	Actions correctives
The pictogram  is displayed	The temperature has not returned to within the ± 4 °C threshold	Check that the door is closed. Check the condition of the door seal. If in the last few hours you loaded your cabinet with a large number of bottles, wait a while then check again. If the alarm is still displayed, contact your EuroCave retailer.
The pictogram  is still displayed even though I have taken the above corrective action	Operating fault	Unplug the cabinet and contact your EuroCave retailer
The pictogram  is displayed	Open door alarm	Ensure that the door is properly shut.
The pictogram  is flashing	The relative humidity level has been < 50 % for more than 72 hrs	<ul style="list-style-type: none"> • Pour a glass of water into the channel of the tray (see chapter 7, § IV). • In order to know how often to add water, count the number of days separating the 1st day you added water and the day when the pictogram was displayed. After a few hours, the pictogram will turn off.
The appliance cannot lower the level of humidity to the desired value		<ul style="list-style-type: none"> • Empty the cabinet, remove the humidity cartridge and clean the tray. • Remove the tube placed at the back of the tray. The humidity will be directly discharged out of the appliance. Contact your EuroCave retailer if the problem persists after you have carried out these corrective actions.
The pictogram  is displayed	Charcoal filter alarm	Replace the charcoal filter (see chapter 5).
The pictogram  is displayed	Temperature sensor fault alarm	Contact your EuroCave retailer.



Your EuroCave Professional wine cabinet is a tried and tested appliance. ??????

9 - TECHNICAL FEATURES



Free-standing range							
	Height mm	Width mm	Depth mm	Weight when empty kg	Permitted temperature T° min °C T° max °C		Consumption per 24 hrs* (kWh)
5083 V/S	950	654	697	55	0	35	0,34
5283 V/S	1744	654	697	84	0	35	0,49
5290	1744	654	697	92	0	35	0,54

Flush-fitting range							
	Height mm	Width mm	Depth mm	Weight when empty kg	Permitted temperature T° min °C T° max °C		Consumption per 24 hrs* (kWh)
5059 V/S	832	594	546**	49	0	35	0,34
5259 V/S	1792	594	546**	78	0	35	0,49

* Consumption per 24 hrs, measured with an external temperature of 20 °C. Control accuracy: ± 1 °C, Display accuracy: ± 1 °C.

** excluding handle (+57mm)

Standards

Your product complies with the following standards:

1 SAFETY 2006/95/CE

Standards EN60335-1 : 2002+A1+A2+A11+A12+A13

EN60335-2-24 : 2003+A1+A2+A11

2 EMC 2004/108/CE

Standard EN55014-1/2



The use of glass doors can alter the performance of your wine cabinet in extreme temperature conditions.

EN

Brand	Reference	Energy efficiency rating	Annual power consumption AEC* (Kwh/yr)	Useful volume (in litres)	Temperature of the other compartments	Sound emission dBA
EUROCAVE PROFESSIONAL	5059V	F	347	119	NA	47
EUROCAVE PROFESSIONAL	5059S	F	383	119	NA	47
EUROCAVE PROFESSIONAL	5259V	F	402	210	NA	42
EUROCAVE PROFESSIONAL	5259S	F	383	210	NA	42
EUROCAVE PROFESSIONAL	5083V	F	402	325	NA	42
EUROCAVE PROFESSIONAL	5083S	G	456	325	NA	42
EUROCAVE PROFESSIONAL	5283V	F	456	433	NA	42
EUROCAVE PROFESSIONAL	5283S	F	456	433	NA	42
EUROCAVE PROFESSIONAL	5290	F	456	421	NA	46



II - STANDARD WINE SERVING TEMPERATURES

French wines

Alsace	10°C
Beaujolais	13°C
Sweet white Bordeaux	6°C
Dry white Bordeaux	8°C
Red Bordeaux	17°C
White Burgundy	11°C
Red Burgundy	18°C
Champagne	6°C
Jura	10°C
Languedoc-Roussillon	13°C
Provence Rosé	12°C
Savoie	9°C
Dry white Loire wines	10°C
Sweet Loire wines	7°C
Red Loire wines	14°C
Rhône wines	15°C
South-West sweet wines	7°C
South-West red wines	15°C

Australian wines

Cabernet franc	16°C
Cabernet sauvignon	17°C
Chardonnay	10°C
Merlot	17°C
Muscat à petit grain	6°C
Pinot noir	15°C
Sauvignon blanc	8°C
Semillon	8°C
Shiraz	18°C
Verdhelo	7°C

Other wines

California	16°C
Chili	15°C
Spain	17°C
Italy	16°C